

# AUSPLOW

PRECISION SEEDING SYSTEMS

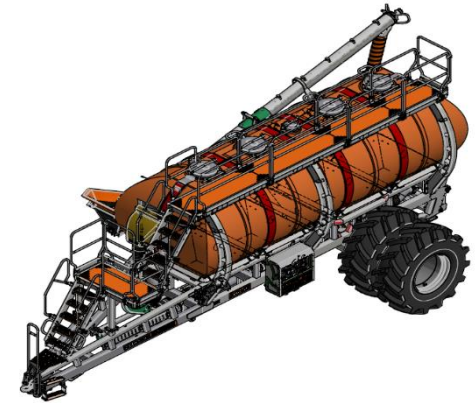

## Spare Parts

## Quick Reference Guide



# Introduction

- This guide is to assist Ausplow Dealers with the identification and ordering of Ausplow Spare Parts.
- It provides a summary of product evolution, key spare parts and the changes made to them.
- It also assists with identifying which Ausplow Spare Parts Manual contains the detailed information on the part in question.
- This guide also explains the procedures involved in placing parts orders via the Ausplow Webshop, returning parts and warranty claims.



# Contents

## Part 1 - DBS Auseeder

- 1.1 DBS Tine Versions
- 1.2 New Products/Changes
- 1.3 Tine Assembly Upgrades
- 1.4 Tine Torque Settings
- 1.5 Liquid Components
- 1.6 DBS Wear Parts
- 1.7 Fert and Seed Boots
- 1.8 Press Wheels
- 1.9 Wing Extensions
- 1.10 Rear Tow Hitches
- 1.11 Drawbars
- 1.12 Coulters
- 1.13 Hydraulic Cylinders
- 1.14 Cables
- 1.15 Axles





# Contents

## Part 1 - DBS Auseeder (cond.)

- 1.16 Stability Wheel
- 1.17 Sectional Control - Granular

## Part 2 - Easitill/Deep Tillage

- 2.1 Easitill Tine Versions
- 2.2 Older Tine Parts
- 2.3 Easitill V1 and V2 Shanks





# Contents

## Part 3 – Multistream

- 3.1 Axles
- 3.2 Hydraulic Filters
- 3.3 Heat Exchangers
- 3.4 Tank Lids
- 3.5 Tanks
- 3.6 Metering Units
- 3.7 Cameras
- 3.8 Air Systems/Hoses
- 3.9 Typical Conversions
- 3.10 Liquid Systems
- 3.11 Series II MS Features

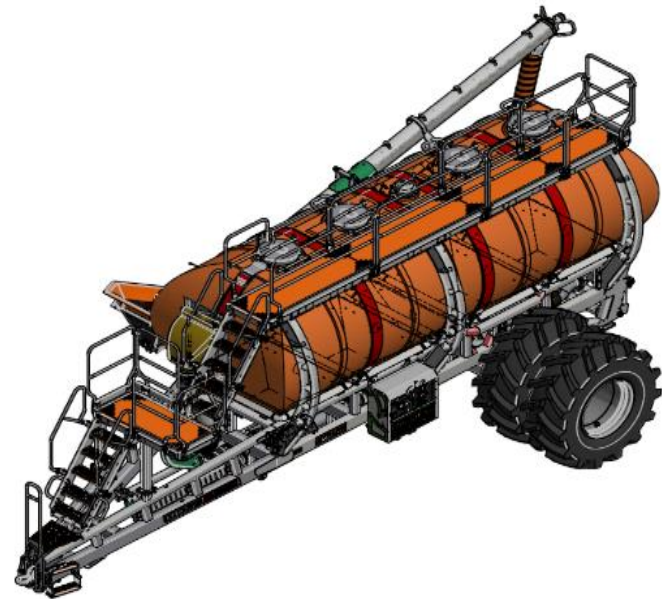



# Contents

## Part 4 - Parts Orders & Web Store

- 4.1 Logging In
- 4.2 Parts Bulletins
- 4.3 Manuals
- 4.4 Search Functions
- 4.5 Fast Order System
- 4.6 Dealer Discounts
- 4.7 Sales Order Notifications
- 4.8 Parts Returns
- 4.9 Freight



Your Cart has 0 items

My Account | Logout | Account : Casual Web User

Home Products FAQs Dealers

### Featured Products



Press Wheel Tyre & Hub 135mm...  
[ \$159.00 ]



Spear Scraper 75mm V4 With ...  
[ \$36.00 ]



Dura Blade Assembly  
[ \$79.00 ]



Pro-D Closing Tool Kit V2 4...  
[ \$71.50 ]



### Product Categories

DBS Auserder  
Multistream Series I  
Multistream Series II  
Deep Tillage  
Ausplow Merchandise  
Miscellaneous

### Refine Products

Multistream Series I [949]

## Part 5 – FAQs

- 5.1 General Public Access
- 5.2 Warranty Claims





# Part 1 – DBS Auseeder

## 1.1 Tine Assembly – Evolution

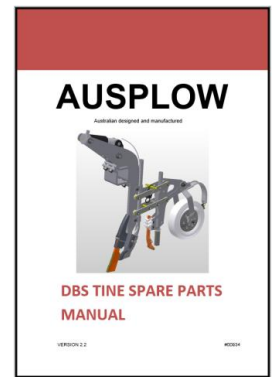

1995 – DBS001-089

1998 – 'S', 'N' & 'E' Series

2006 – 'D' Series

2016 on - 'D' Series

Version 1

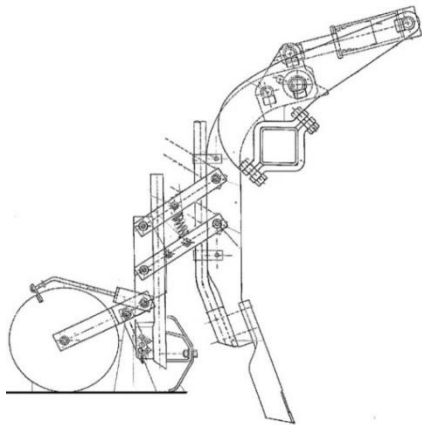

Version 2



Version 3

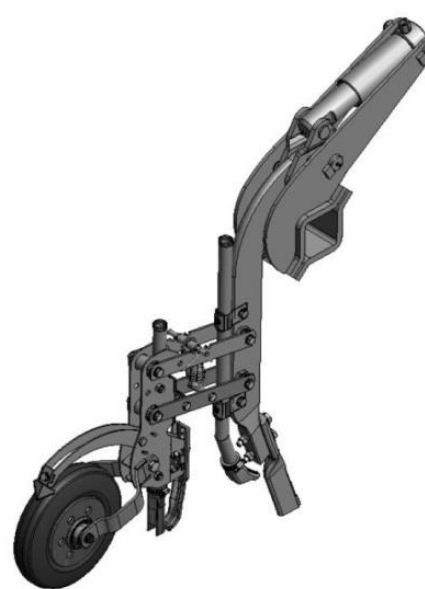

Version 4

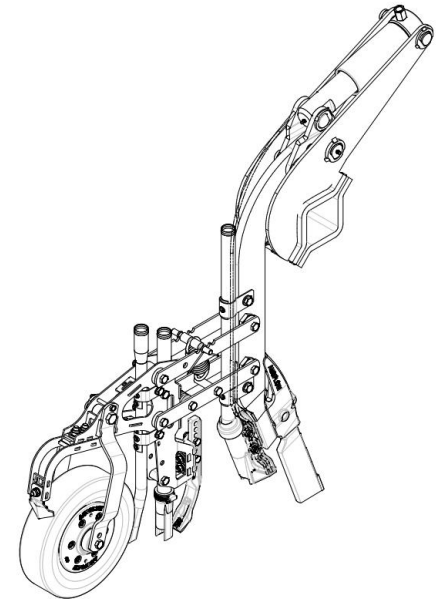



# DBS Auseeder

## 1.1 Pre-Version 1 Tine

Parallelogram fitted to spring type tines.

## 1.1 Version 1 Tine

- Banana Shaped Closing Tool
- Hydraulic controlled shank

The majority of these parts are no longer available.

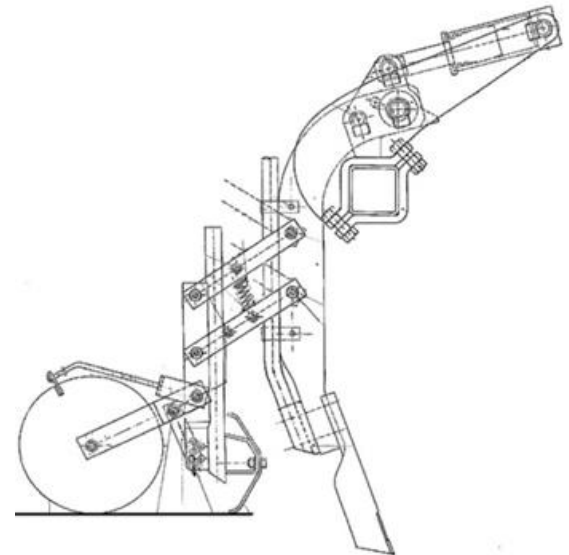



# DBS Auseeder

## 1.1 Version 2 Tine - characteristics

- Black steel fertiliser tube
- Black steel seed tube
- 3 notch - short side arms
- Fertiliser boots 39mm & Finger
- Short scraper
- Seed boots 42mm ID
- Straight PW arms

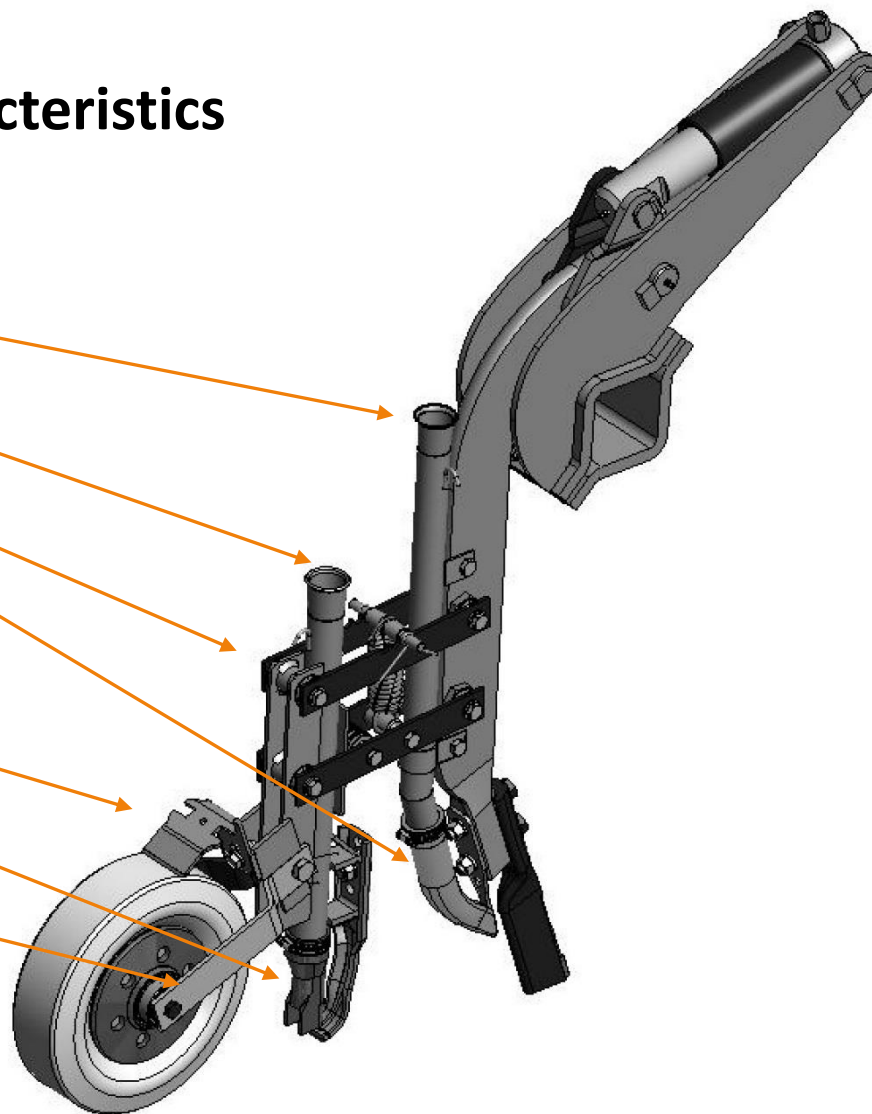



# DBS Auseeder

## 1.1 Version 3 Tine - characteristics

- Fertiliser tubes Stainless Steel - 32mm
- Longer side arms (by 50mm) – 4 notch
- Seed tubes Stainless Steel - 32mm
- Upgraded Rib Assembly
- 32mm Seed and Fert Boot
- Longer Scraper Arm and Spear Scraper
- Curved Press Wheel arms

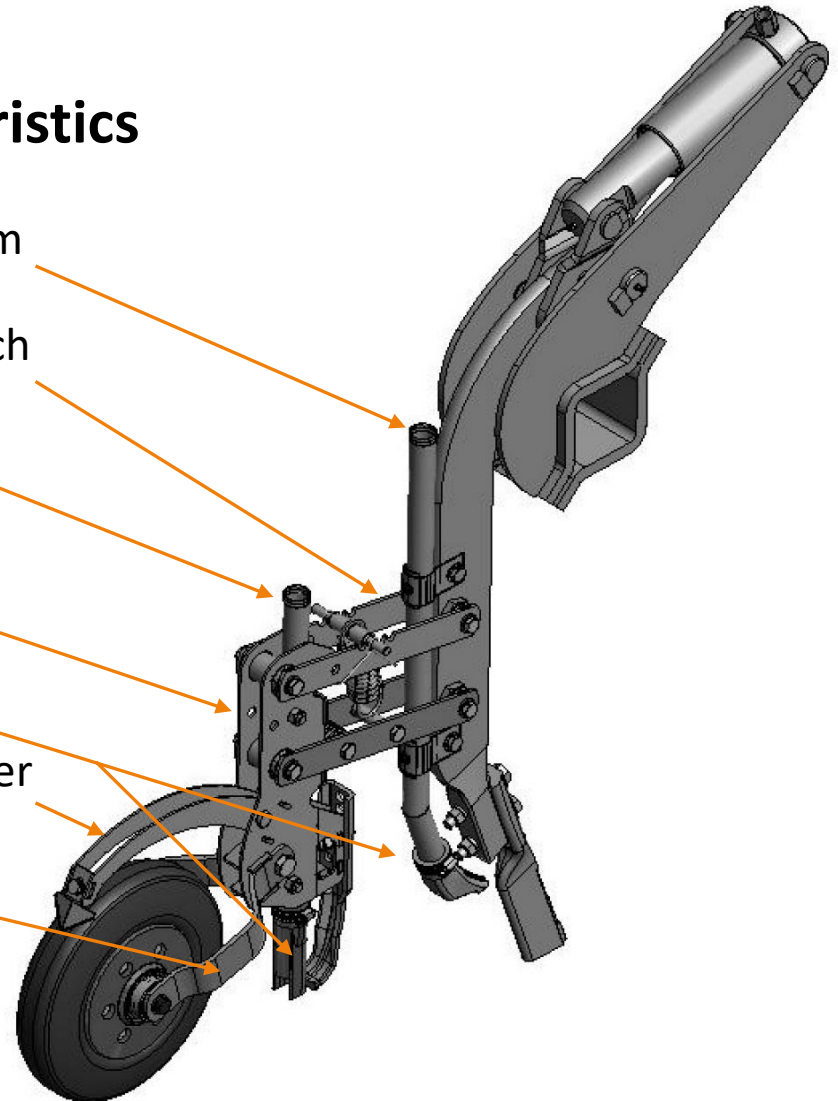



# DBS Auseeder

## 1.1 Version 4 Tine - characteristics

- Fitted with Pro-D ground engaging tools
- Upgraded rib assembly for greater clearance
- Upgraded Shielded Fert boot
- Upgraded Closing Tool and adaptor
- Provision for 3 liquid locations
- Upgraded PW arm  
to cater for all press wheel sizes
- Upgraded scraper arm and spear scraper

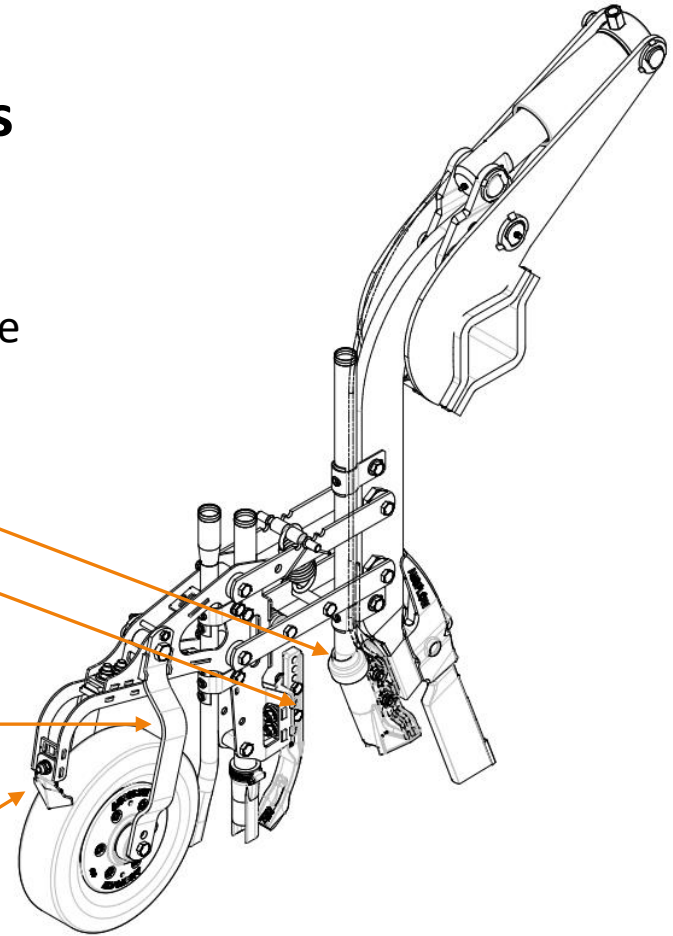



# DBS Auseeder

## 1.2 New Products

### New V2 Closing Tool & Adaptor (2019)

- Improved durability and use
- Parts Bulletin 1-19 explains changeover
- Not interchangeable with V1 CT and adaptor → 
- Paired Row also uses the new V2 Adaptor

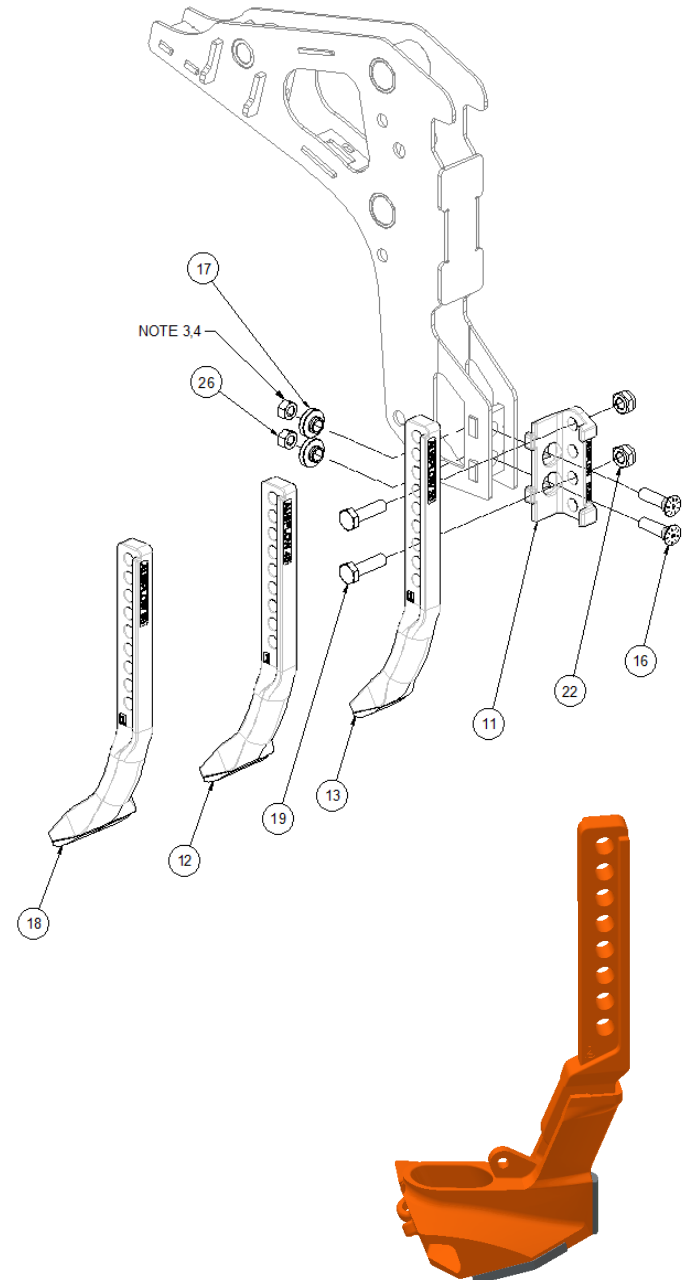



# DBS Auseeder

## 1.2 New Products

### New Scraper Arm for V4 Tine (2020)

- Improved durability and use
- Parts Bulletin 4-20 explains changeover
- New arm and mount block sold as kit #27491
- Made shorter in 2023 for increased robustness
- Old scraper arm kit 27491 NLA.
- Special offer for machine change outs that have the old scraper arm, see Bulletin 4-20 for details.





# DBS Auseeder

## 1.2 New Products

### New Shielded Fert Boot Kit V2 (2022)

- Improved durability and use
- Parts Bulletin 2-22 explains changeover
- Sold as kit #03136
- Older Fert boot and Shield are not

interchangeable with new  
Shielded Fert Boot Kit  
(Boot and strap avail  
until stock runs out)





# DBS Auseeder

## 1.2 Tine Assy Side Arm Washer Removed 2021

- Tine assembly side arm bolts are now slightly shorter
- Only one #09031 M12 Washer is now used in these kits:
- #01230 Bolt Set
- #11477 Shank to Side Arm Bush Kit
- #11940 Seeding Unit Rib Kit
- Parts Bulletin 6-20 refers.

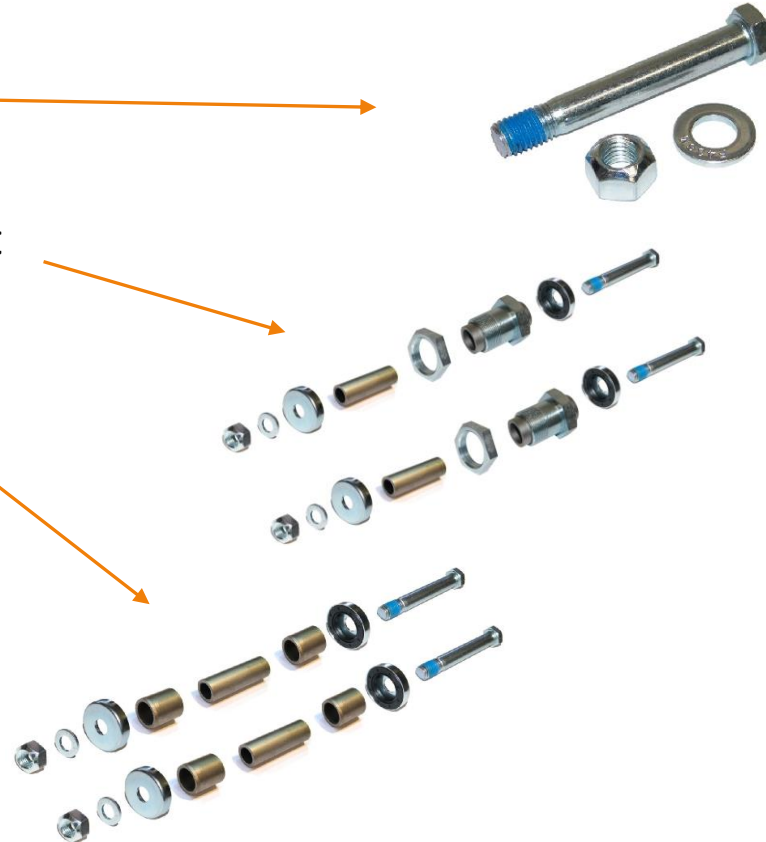
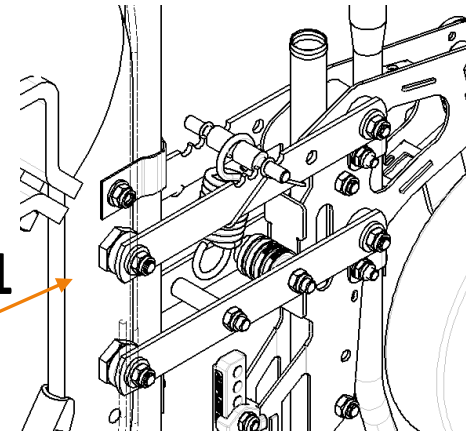



# DBS Auseeder

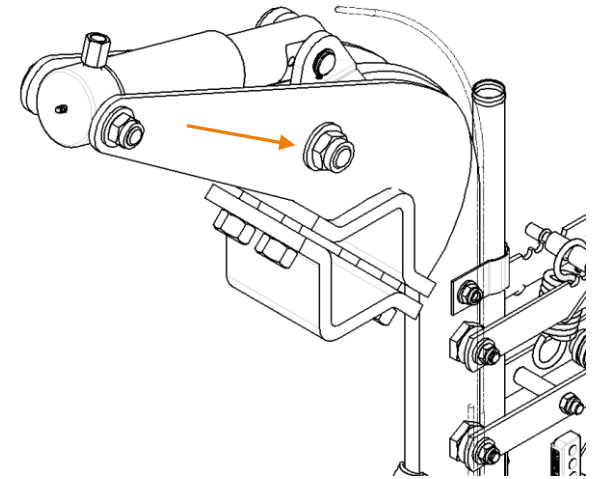

## 1.2 Shank Pivot Pin Special Washer

- Due to longer shank pivot pins 01368, a Special washer #33623 was fitted to new DBS/Easitill machines during 2020 and 2021.
- They have a recessed section that needs to face the pivot bracket to ensure the cheek plates are held together correctly.
- Late 2021 the 01282 Shank Pivot Pin set now contains a standard washer & pin
- M24 nut to be tightened to a torque of 200Nm.

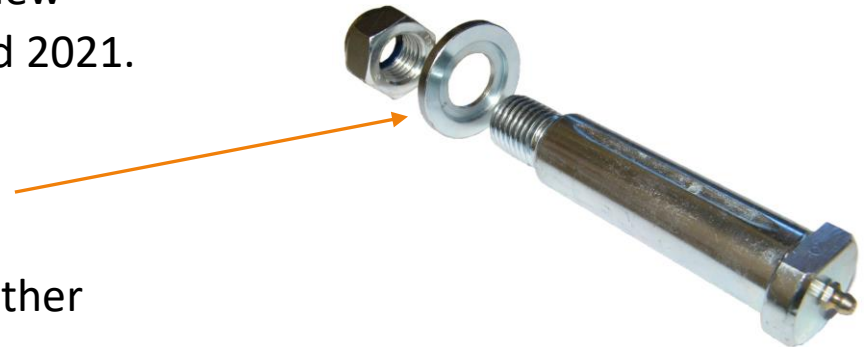



# DBS Auseeder

## 1.3 Tine Upgrades

### Adding Pro-D to V2 and V3 Tines

- V2 Tines require
  - # 15832 - SS Fert Tube Upgrade Kit
- V2 and V3 Tine Assy can add Pro-D Kits:

- Blade Adaptor



- NEW 2022 Fert Shielded Boot



- Closing Tool & Adaptor

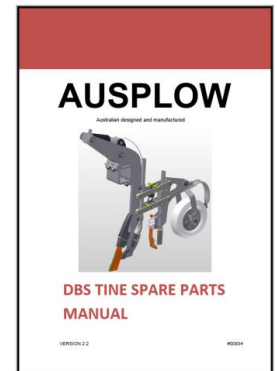



# DBS Auseeder

## 1.3 V2 & V3 Tine Upgrades

- Rear Scraper Arm Kit #27221

For **V3 ONLY** - Not Assembled

- V4 Rib Upgrade Kit #27220 – Not Assembled

For **V2 and V3**

- V4 Seeding Unit Kit #11939 – Not Assembled

➤ For **V2 and V3**

➤ Need to order V4 scrapers to suit

➤ Contains new scraper arm

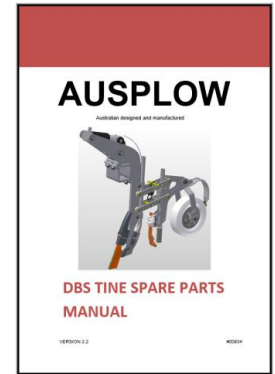



# DBS Auseeder

## 1.4 V4 Tine Torque Settings

This is added to the:

- Tine Spare Parts Manual
- Auseeder Operators Manual

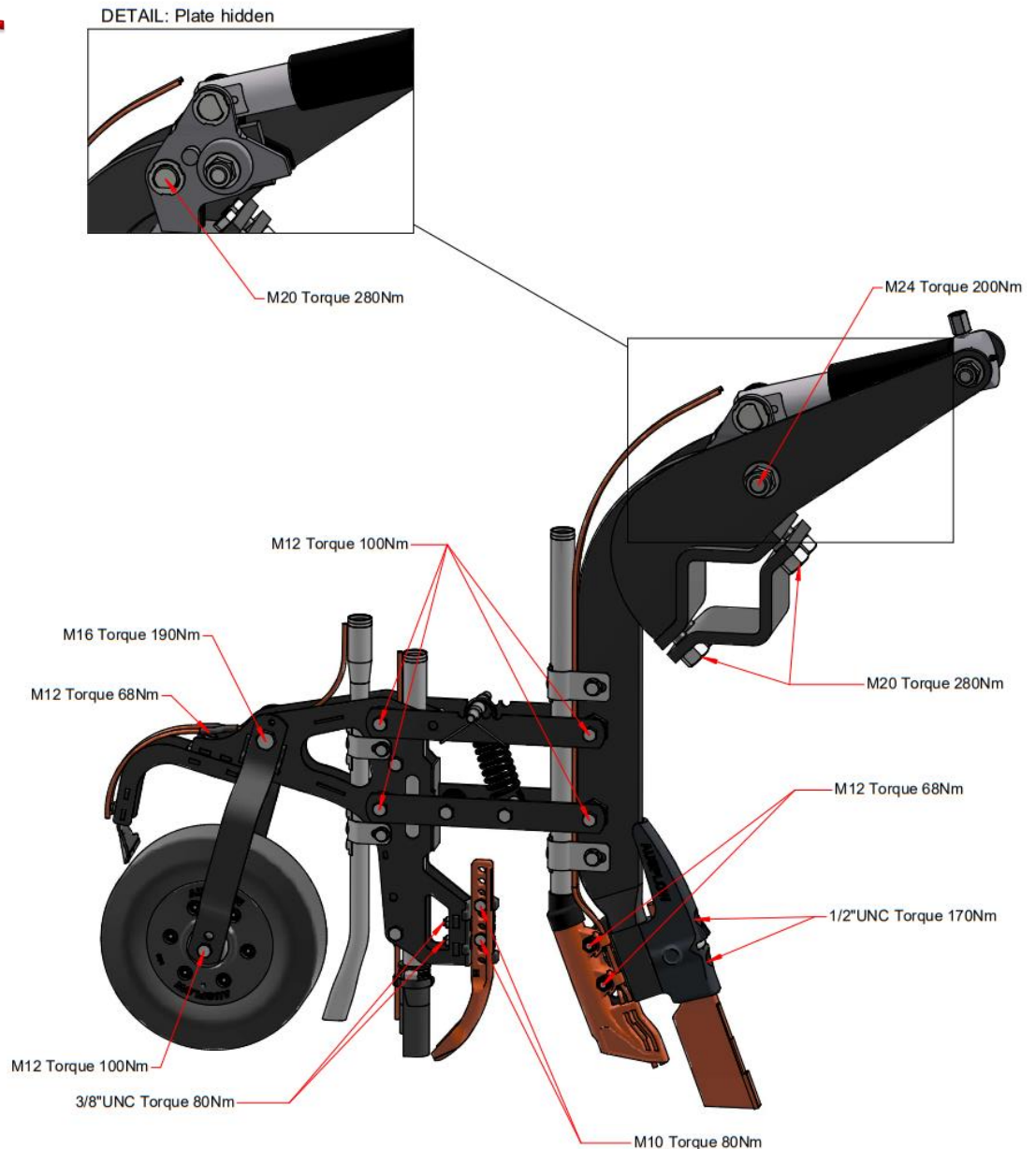



# DBS Auseeder

## 1.5 Version 2 Tine - with liquid

- Liquid nozzle #04028 on scraper

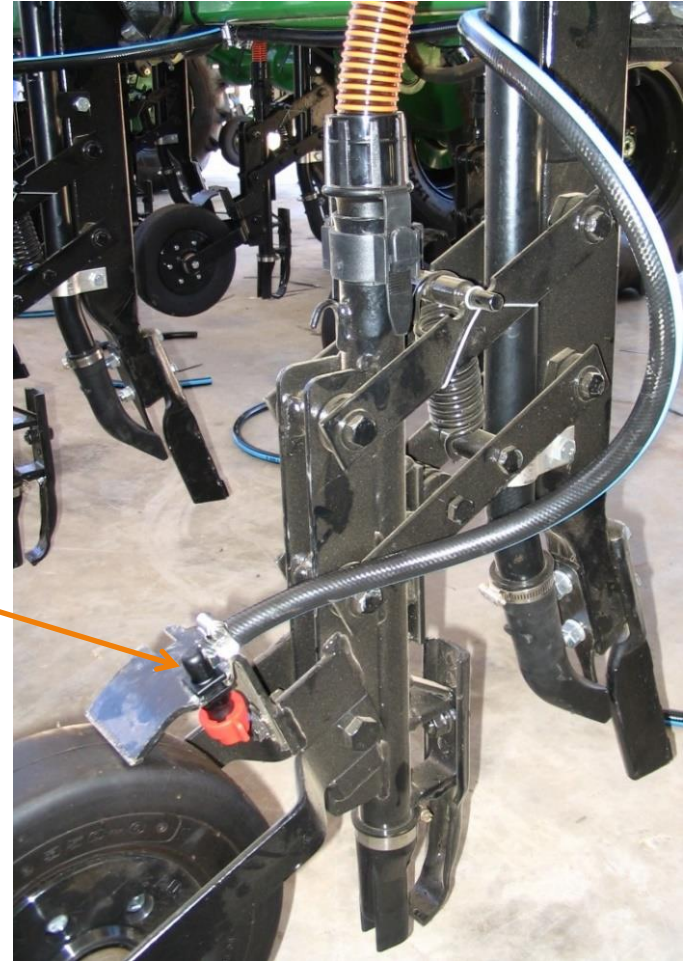



# DBS Auseeder

## 1.5 Version 3 Tine - with Liquid

SS Liquid Tubes used for:

- Deep Banding #11363
- Seed Placement #11381

Convert to Friction Flow:

- Remove orifice in nozzle holder
- Add 3m, 4m, 5 or 6m Suzi Coil Kit
- Chamfer the top of the stainless steel tube to accommodate the 09735 coupling.
- Fit the straight coupling (#09735) between the stainless tube and suzi-coil.

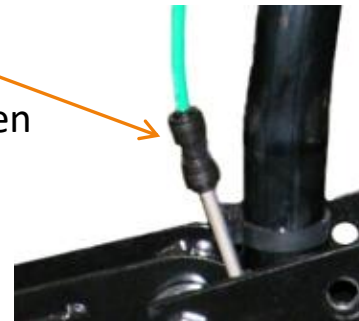
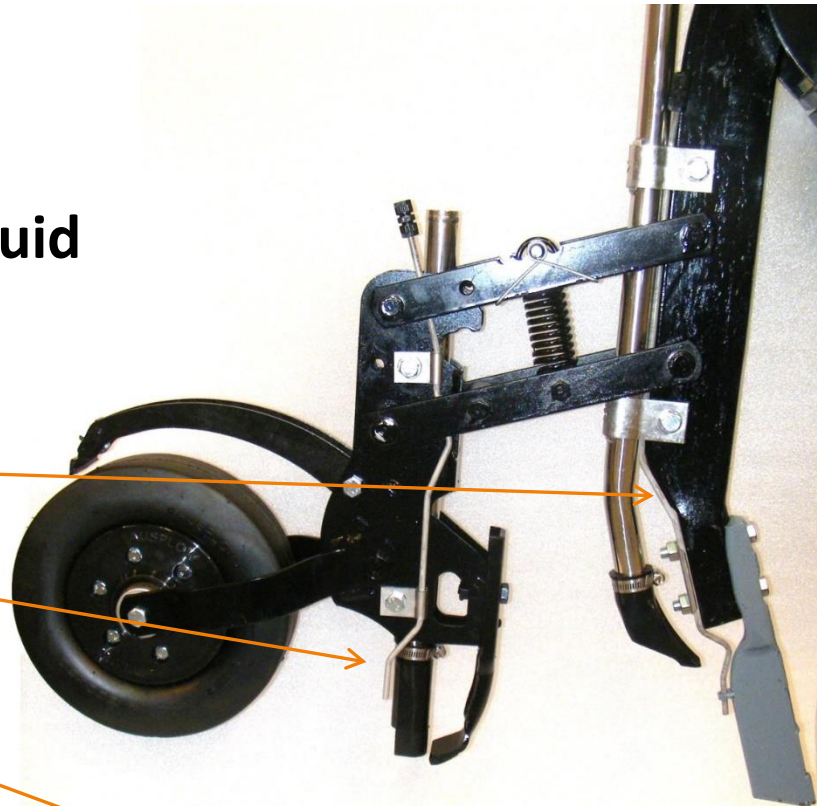



# DBS Auseeder

## 1.5 Version 4 Tine - with nozzle liquid system (Superceded)

- Deep Banding 6mm Nylon Tube
- Seed Placement SS Tube
- Rear Liquid (not shown)

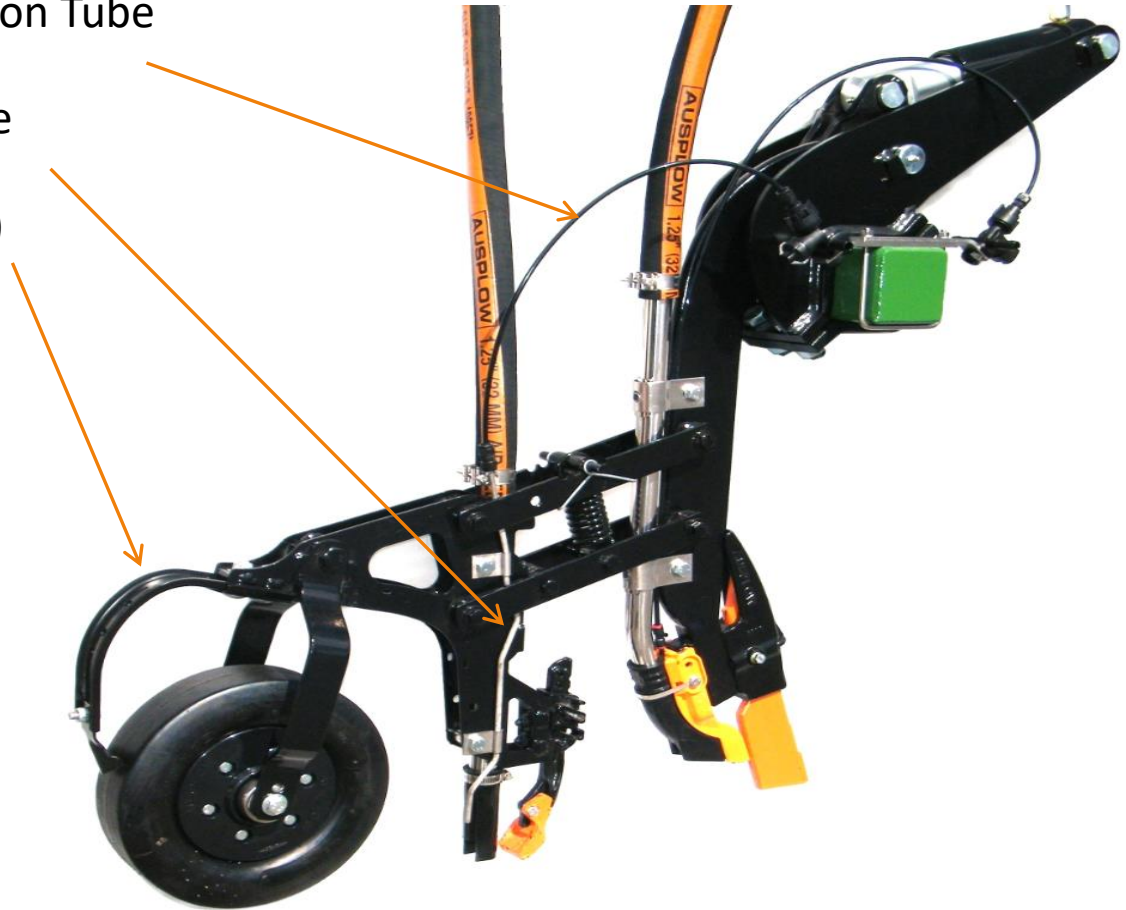



# DBS Auseeder

## 1.5 Version 4 Tine - Friction Flow Liquid System

### Same Suzi Coil used for:

- Deep Banding
- Seed Placement
- Options for Rear Liquid  
(Dual or Single stream)

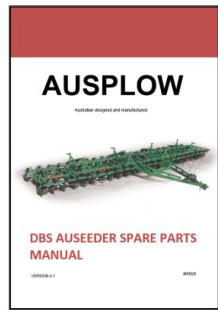



# DBS Auseeder

## 1.5 Liquid Kits - Friction Flow

### Need to order two parts:

#### ❖ Liquid Kit to suit the Model bar:

- eg Liq Kit 70 Tine Friction flow 8 Run D260-70
- Contains manifolds, stands, hoses etc

#### ❖ Suzi Coil to suit application rate by the No of tines, eg: 70 x 15569 suzi coil 4m

### Friction Flow Coil – (see Operators Manual for flow rates)

#15570	Suzi Coil 3m Coil 6mm OD x 2mm ID - Orange
#15569	Suzi Coil 4m Coil 6mm OD x 2mm ID – Orange (Standard)
#15568	Suzi Coil 5m Coil 6mm OD x 2mm ID - Orange
#11223	Suzi Coil 6m Coil 6mm OD x 2mm ID – Orange
#11219	Suzi Coil 4m Coil 6mm OD x 1.5mm ID - Green

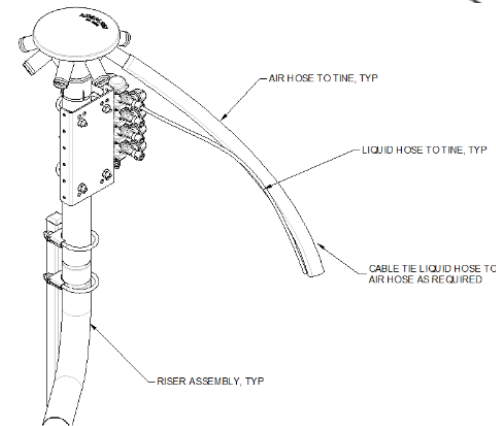
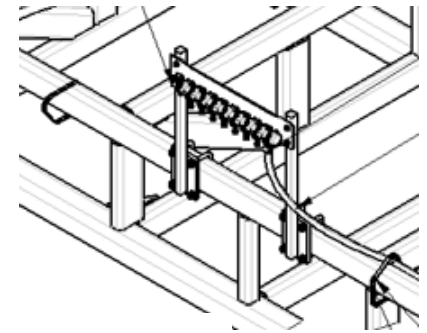



# DBS Auseeder

## 1.6 DBS Blades

- **DBF** 5" and 6" .....for 'C' Shank
- **DBA** 5" 6" 7" 8" 9"
- **DBA Liquid** 6" 7" 8" 9"
- **PRO-D** 5-7" 7-9" and NEW - #33358 7-9" Double Burster (grey containing two burster tiles for longer life)

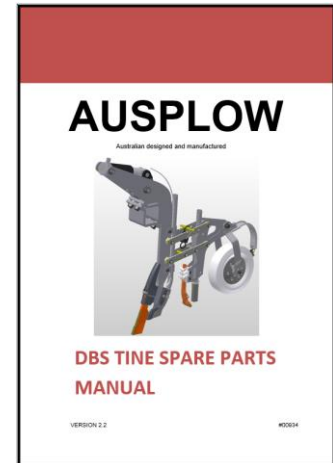

**DBF**



**DBA**



**DBA liquid**



**Pro-D 5-7**



**7-9**



**Double Burster**



# DBS Auseeder

## 1.6 Closing Tools

- Sizes: 30mm, 45mm & 60mm

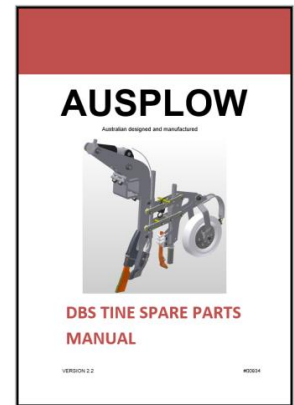

Double Tung  
Released 1995

Obsolete



1 Piece Tungsten  
Released 1998

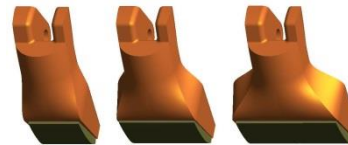

Pro-D Tip  
2015 - 2019

Obsolete

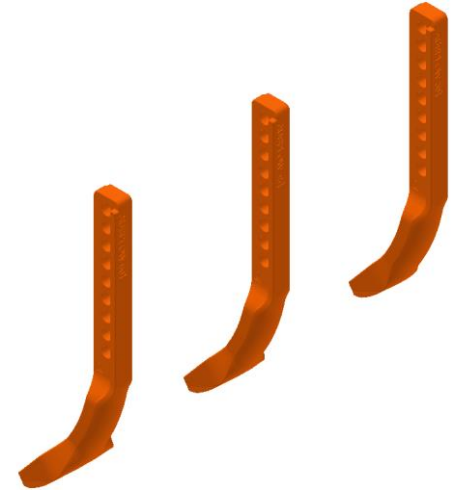

1 Piece Pro-D CT  
2019 on

Also in kit form  
with adaptor





# DBS Auseeder

## 1.6 Scrapers



Bent 70 & 90mm  
1998-2006  
**V2 Tine Assy**



Spear 50mm  
2007-2015  
**V3 Tine Assy**



Flat 70 & 90mm  
2007-2015  
**V3 Tine Assy**



75 & 110mm Scraper  
2016 on  
**V4 Tine Assy**



90 & 110mm Curved Scraper  
2019 on  
**V4 Tine Assy**



135mm Curved Scraper  
2020 on  
**V4 Tine Assy**



V Wheel Scraper  
2017 on  
**V4 Tine Assy**



V Flat Wheel Scraper  
2021 on  
**V4 Tine Assy**

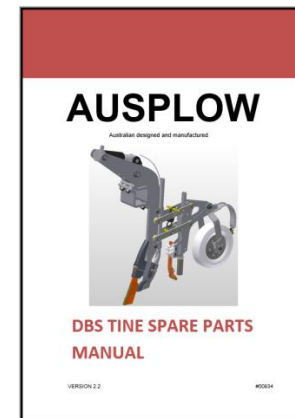



# DBS Auseeder

## 1.6 Paired Row – New stem 2019 - #32043

- Combines Closing Tool and Seed Boot
- Used with Pro-D V2 CT Adaptor

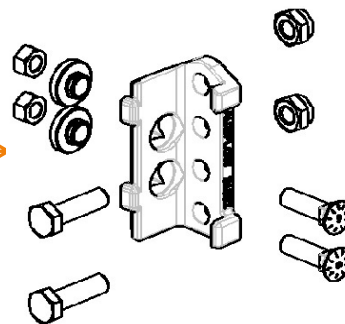

- Adaptor for V2 Tines



28686 Pair Row Adaptor for V2

- Paired row spacing for the following DBS tine spaced bars:

260mm	- 7 inch, 3 inch approx.
300mm	- 9 inch, 3 inch approx.
381mm	- 12 inch, 3 inch approx.



Photo demonstrates 3 x paired rows from a 260mm tine spaced DBS Auseeder.



# DBS Ausseeder

## 1.7 Fert & Seed Boots



V3 Tine - 32mm dia.



**NEW V4 Tine Pro-D – Shielded Fertiliser Boot 33953**

15794 is No Longer Available



**Seed boots for V4 same as for V3**



# DBS Auseeder

## 1.8 Press Wheel Assemblies

50mm, 70mm, 90mm, & "V Flat"



Can be purchased as:



- Press wheel tyre only
- Press wheel tyre & hub assembly
- Press wheel assembly with bearings and seals
- Press wheel assembly with bearings, seals and spacers

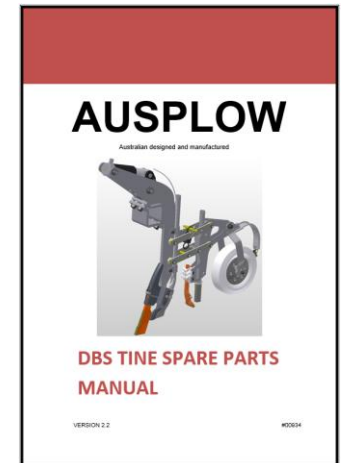
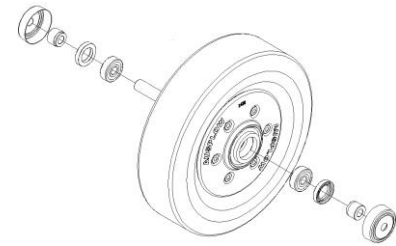



# DBS Auseeder



## 1.8 Press Wheel Assemblies – Rounded 90, 110, 135mm

### For improved performance in sandy conditions:

- Uses existing Press Wheel hubs



- Can be fitted to V3 and V4 Tine assemblies

- Cannot be fitted to V2 Tine assemblies if fitted with old type Press Wheel arms – use V3 PW arm 11131

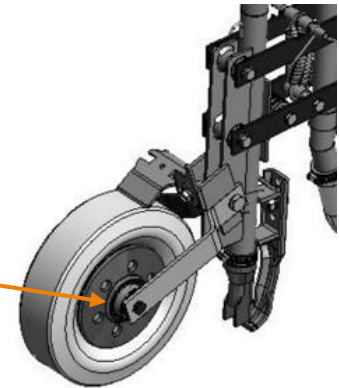

- Used with new hard faced 90 and 110mm or 135mm Rounded scrapers for V4 Tines





# DBS Auseeder



## 1.9 Wing/Tine Extensions

**ONLY FOR 3 FRAME MACHINES**

### **Information required**

- Machine serial number.
- Pictures of the machine's outer wings.
- Tine assemblies - ie: Version - V2, V3 or V4
- Air delivery system fitted - ie: 5" or 6", double shoot or single shoot.

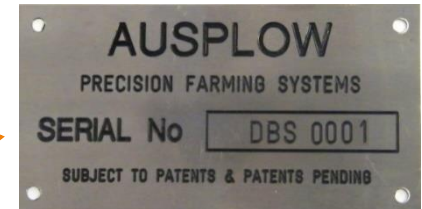



# DBS Aus Seeder

## 1.9 Tine Extensions

**Note: NOT TO 5 FRAME MACHINES**

### ❖ Single Wheel on Wing:

No more than three tines can be placed outside a single wing wheel.

### ❖ Dual Wheel on Wing:

#### Condition 1:

The number of tines between the wing hinge point and the inside of the inner wheels is at least double the number of tines outside the wheel

#### Condition 2:

The total number of tines on a wing cannot exceed the number of tines on the centre frame

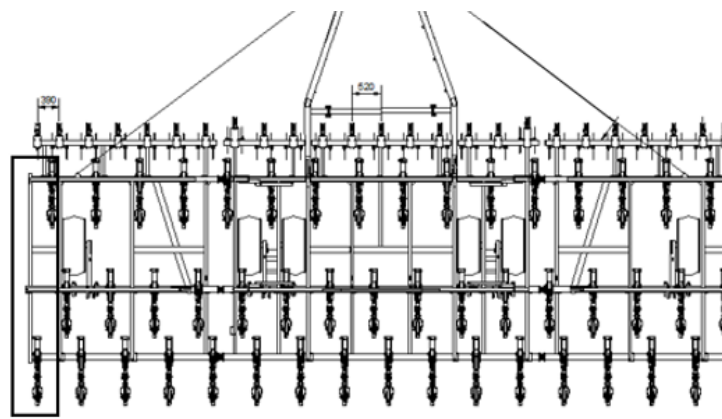

Max 3 Tines allowed outside the single wheel wing

#### Condition 1:

# of tines here..  
...is double the # here

#### Condition 2:

# of tines here..  
...Not exceed # here

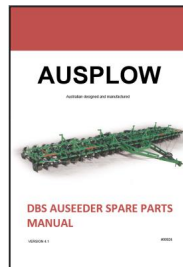
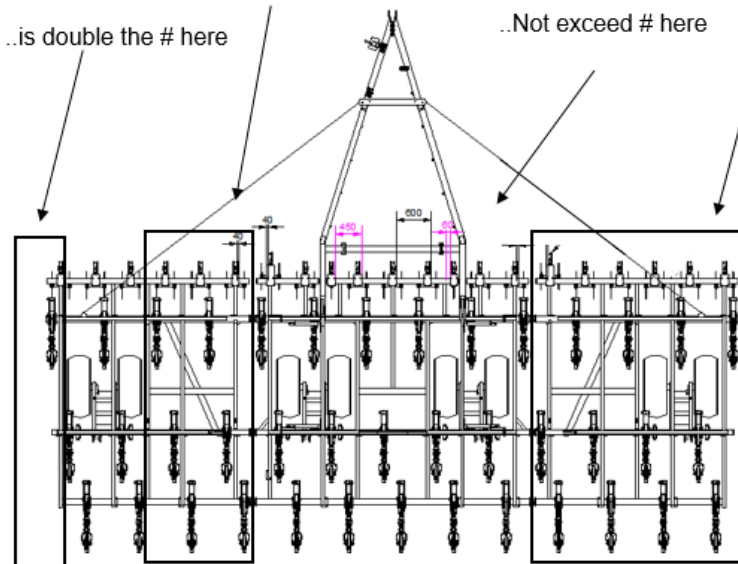



# DBS Auseeder

## 1.9 Tine Extensions

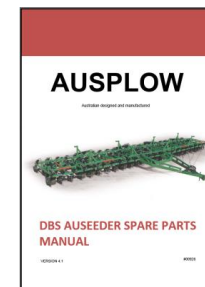

Model	Outer Wing Axle	Single Tyre Outer Wing Tines Outside the Wheels (max of 3)	Dual Tyre Outer Wing Cond 1: Tines hing to inner wheel/Tines outside wheel Cond 2: Tines on wing/Tines on centre frame	Recommended Extensions according to policy	Max No of Extra Tines added per machine
36-260N	Single	2		A1	2
42-260N	Single	2		A1	2
48-260N	Single	2		A1	2
48-260N	Dual		Cond 1: 9/2 Cond 2: 16/16	Nil due to Cond 2	0
32-300N	Single	0		A1 or B1	4
36-300N	Single	2		A2	2
40-300N	Single	1		B2 - Solid tine stub	4
40-300N	Dual		Cond 1: 6/1 Cond 2: 12/16	B2 - Solid tine stub	4
48-260E	Single	2		A1	2
48-260E	Dual		Cond 1: 6/2 Cond 2: 13/22	A1 - due to Cond 1	2
54-260E	Dual		Cond 1: 9/2 Cond 2: 16/22	A1 or B1	4
60-260E	Dual		Cond 1: 9/5 Cond 2: 19/22	Nil	0
39-300E	Single	2		A1	2
43-300E	Single	2		A1	2
43-300E	Dual		Cond 1: 6/1 Cond 2: 12/19	B2 - Solid tine stub	4
49-300E	Dual		Cond 1: 9/1 Cond 2: 15/19	A1, B1 or C2	6
D260-32	Single	0		A1, B1 or C1	6
D260-36	Single	2		A1	2
D260-42-6	Single	2		A1	2
D260-42-8	Dual		Cond 1: 6/2 Cond 2: 13/16	A1 - due to Cond 1	2
D260-48N	Dual		Cond 1: 9/2 Cond 2: 16/16	Nil due to Cond 2	0
D260-48E-6	Single	2		A1	2
D260-48E-8	Dual		Cond 1: 6/2 Cond 2: 13/22	A1 - due to Cond 1	2
D260-54	Dual		Cond 1: 9/2 Cond 2: 16/22	A1 or B1	4
D300-32	Single	0		A1, B1 or C2	6
D300-36	Single	2		A1	2
D300-40-6	Single	1		B2 - Solid tine stub	4
D300-40-8	Dual		Cond 1: 6/1 Cond 2: 12/16	B2 - Solid tine stub	4
D300-46	Dual		Cond 1: 9/2 Cond 2: 15/16	B1 - Remove bolted tine stub, add 1 extra tine	2
D300-49	Dual		Cond 1: 9/1 Cond 2: 15/19	C2 - Remove bolted tine stub, add 2 extra tines	4
D300-51	Dual		Cond 1: 9/2 Cond 2: 16/19	B1	4



# DBS Auseeder

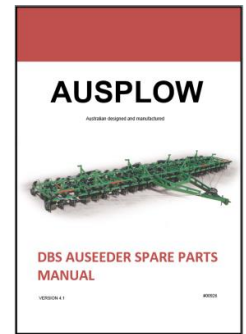

## 1.10 Rear Tow Hitches – Multifit for Series I & II Bars

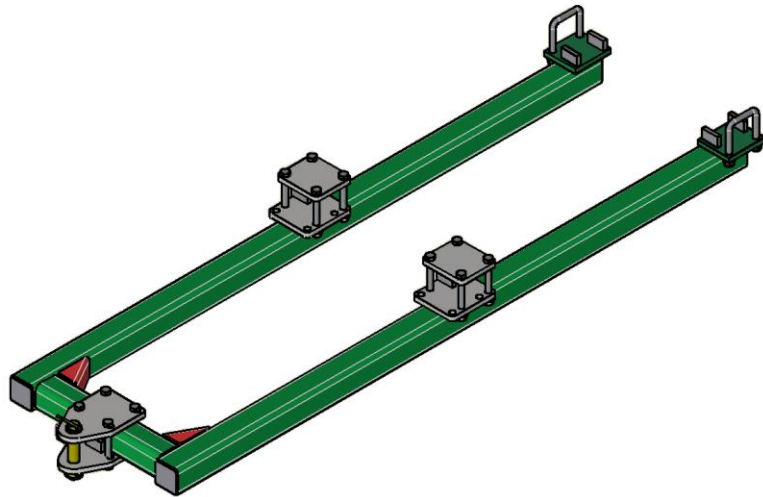

Rear Tow Hitch Kit – Narrow #13599

All Bars except .... D300-49,51,55,60T,61

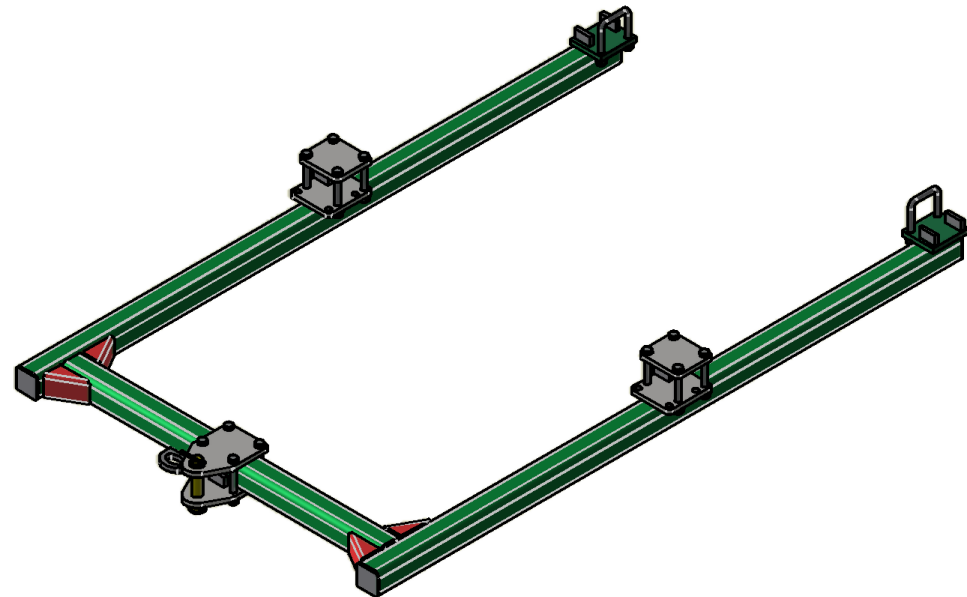

Suitable for ..... D300-49,51,55,60T,61 &  
D381-36,40

For D381-28,32,44,48 use #28146 and D260-59 series I  
use #27840-A



- Extended Top Rails
- New Cable Stay Bracket and new bolts and plate
- 7 Hole Hitch Plates

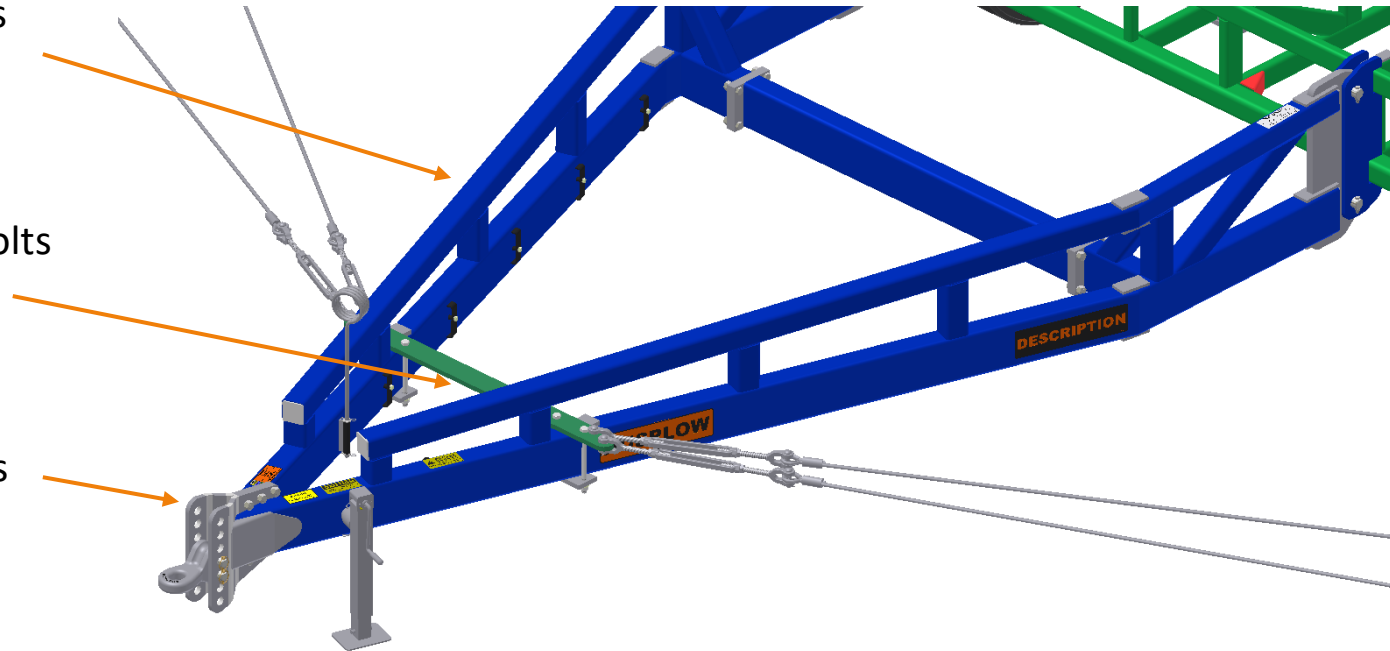



- Older Series I Drawbars & cable brackets still made for spare parts
- Series II Drawbars now replaced by Series II Active Drawbars
- Series II Active Drawbars and Link can replace Series I if ordered as a set (LH and RH)

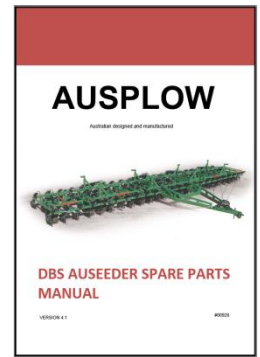

# DBS Auseeder

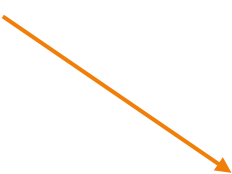

## 1.11 Series II Active Drawbar - 2022 Onwards

- Active Drawbar Links 
- Extended Top Rails 
- 7 Hole Hitch Plates 
- Series II Active Drawbars require the Active Drawbar Link Kit 34245 
- Front section of the Auseeder Spare Parts manual shows drawbar part numbers



# DBS Auseeder

## 1.12 Coulter Assembly – Evolution

Limited Parts Available

Version 0



1995 to 2008

Version 1

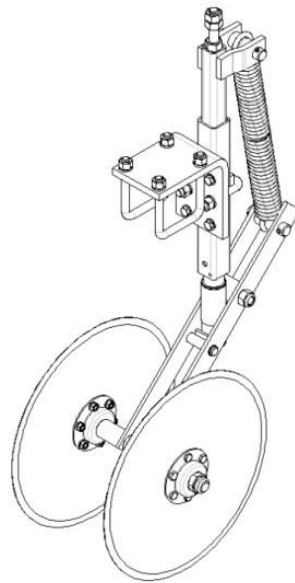

2009 – 2016

Version 2



**CURRENT**

2016 - onwards

Version 3

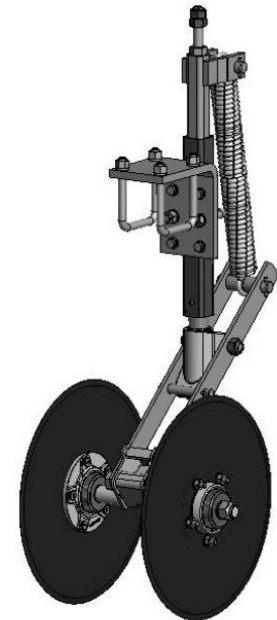



# DBS Auseeder

## 1.12 Version 1 Coulter Assembly – Pre 2009

- Six hole 18" coulter disc

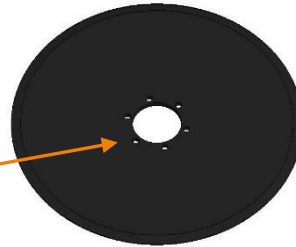

- Steel swivel assembly

- Axle threaded both ends

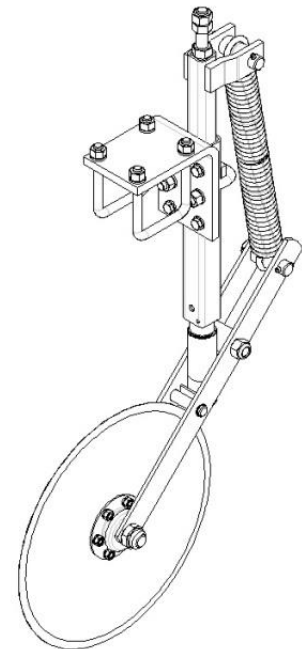
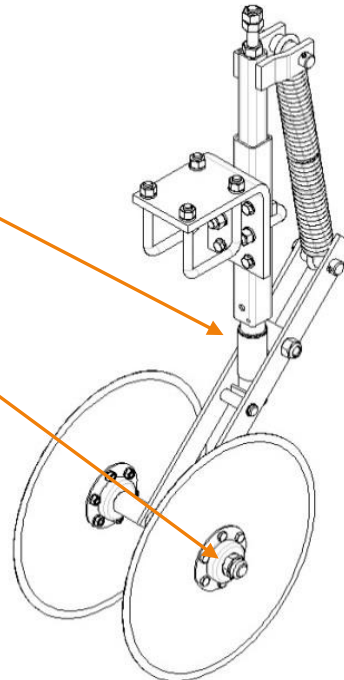



# DBS Auseeder

## 1.12 Version 2 Coulter Unit – 2009-2015

- Five hole 18" coulter disc
- Upgraded hub assembly – easier disc fitting
- Upgraded cast knuckle assembly – 1" wider
- Upgraded axle (one end threaded)

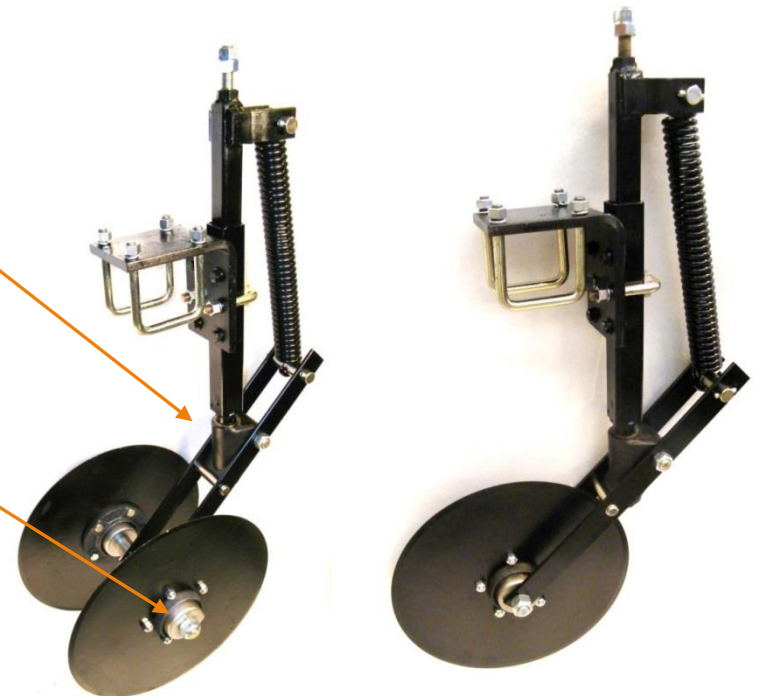
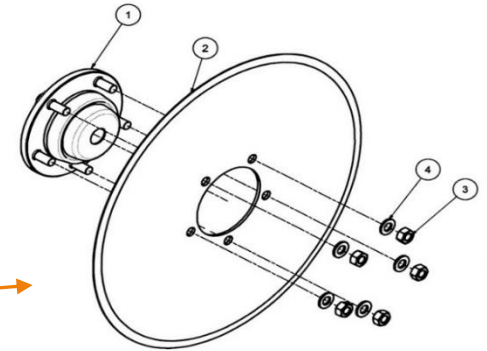



# DBS Auseeder

## 1.12 Version 3 Coulter Unit - Current

- Top end the same as the V2 - new axle and hub
- Upgraded hub with bigger bearing  
**parts not interchangeable with V2 hub !**
- Bolt on axle design to fit onto V2 assemblies

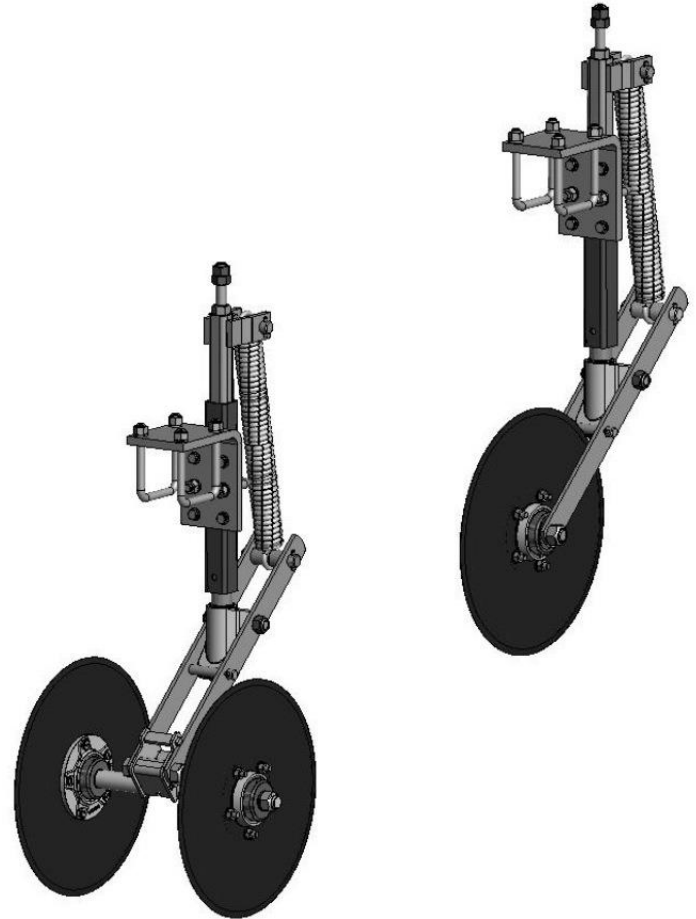
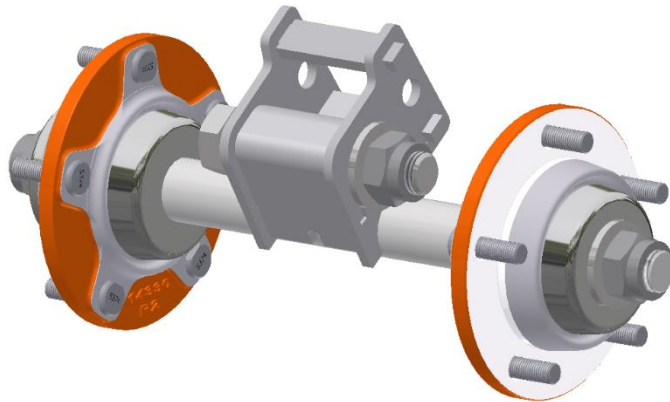



# DBS Auseeder

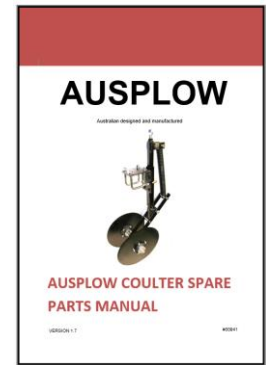

## 1.12 Version 3 Coulter Hub - Current

- V3 Coulter Hub Assembly – (painted orange)  
parts not interchangeable with V2 hub!
  - Upgraded hub with bigger bearing
  - Different seals and spacers
  - Only deflector cup and circlip same as V2
- V2 Coulter hubs parts available except the hub...need to order new hub assembly #27893

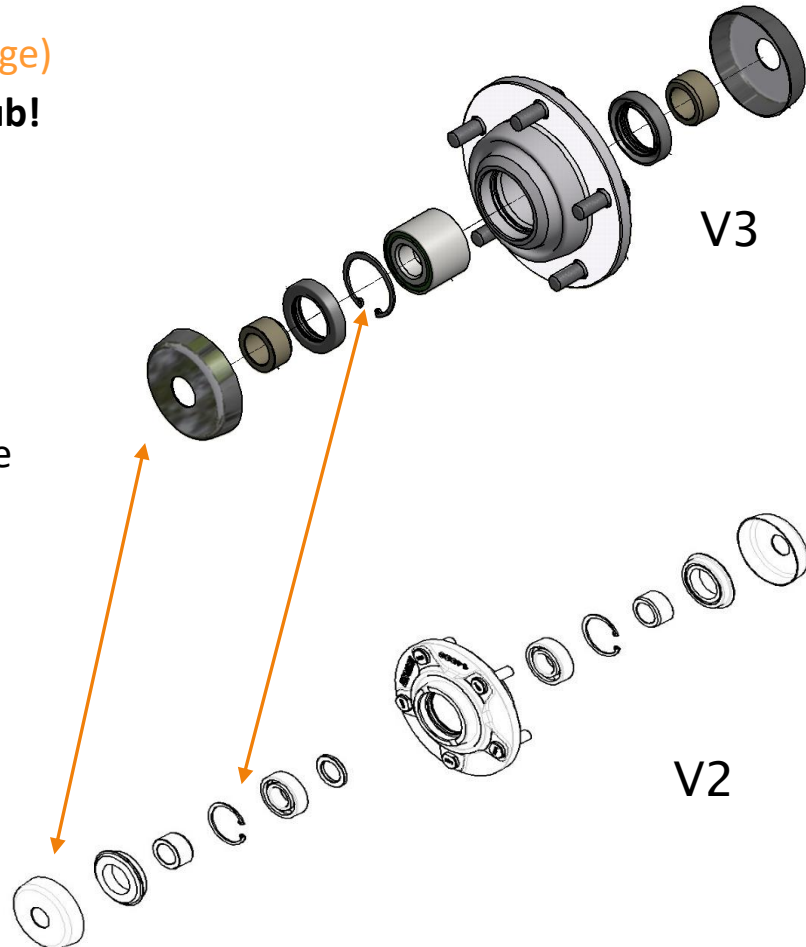



# DBS Auseeder

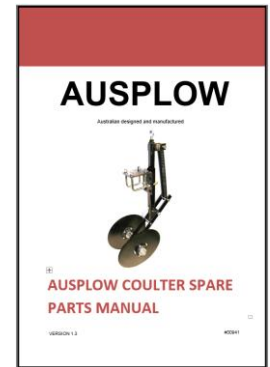

## 1.12 Converting from Version 1 to Version 3

➤ Kit 03685 to convert Version 1 (narrow) units are NLA.

➤ V1 Coulter Swivel Assy – NLA



➤ To convert V1 Swivel Assy to current 03664 Coulter Swivel Assy order these parts for each coulter

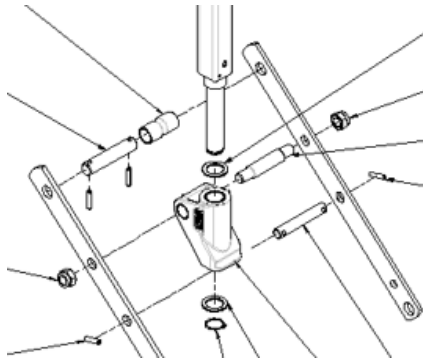

Qty	Part#	Description
4	03168	Roll Pin 8 Dia x 40mm LG
1	03665	Coulter Stop Pin
1	03666	Coulter Pin – Spring Lower
1	03667	Coulter Pivot Pin
1	03668	Coulter Sleeve Spring Mount
1	03664	Coulter Swivel Assy
2	09002	Nut M20 ZP Conelock



# DBS Auseeder

## 1.12 Coulter Kits

- Coulter Bar Set (bars only) or
- Coulter Bar Kit (bars & U bolts)
- Coulter Kits (bars, U bolts and coulters)

### Information Required

- Machine serial number.
- Flat or Ripple Coulter Disks
- Most coulter kits are listed in whole goods price pages.

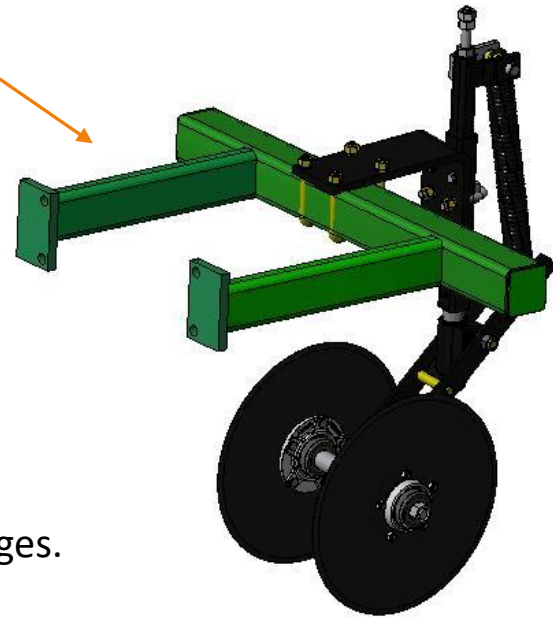
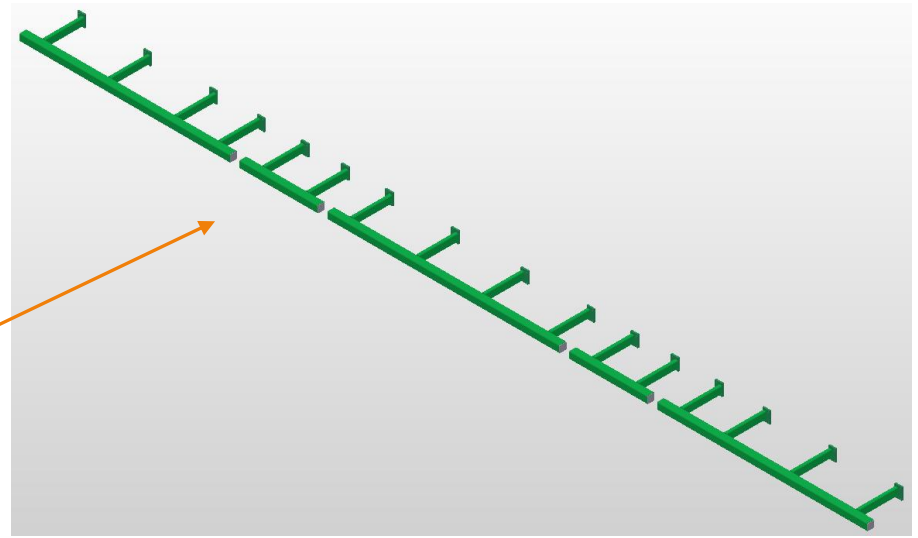



# Easitill & DBS Auseeder

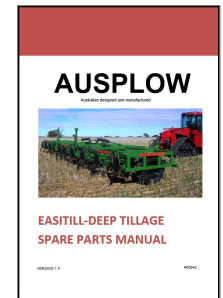
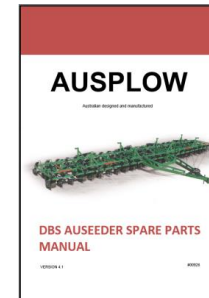

## 1.13 Hydraulic Phasing Cylinders

- ▶ Before ordering replacement seal kits:
  - ▶ 1. Determine if it is a Phasing (wheel axle) cylinder or Wing Fold (wing lift) cylinder.
  - ▶ 2. Determine what manufacture type cylinder it is:  
Up to 2009 & 2022 on ..... Alford Cylinders  
2009 to 2022 ..... Baker Cylinders
  - ▶ 3. Determine what size it is:

**Alford** – mid 2024 onwards

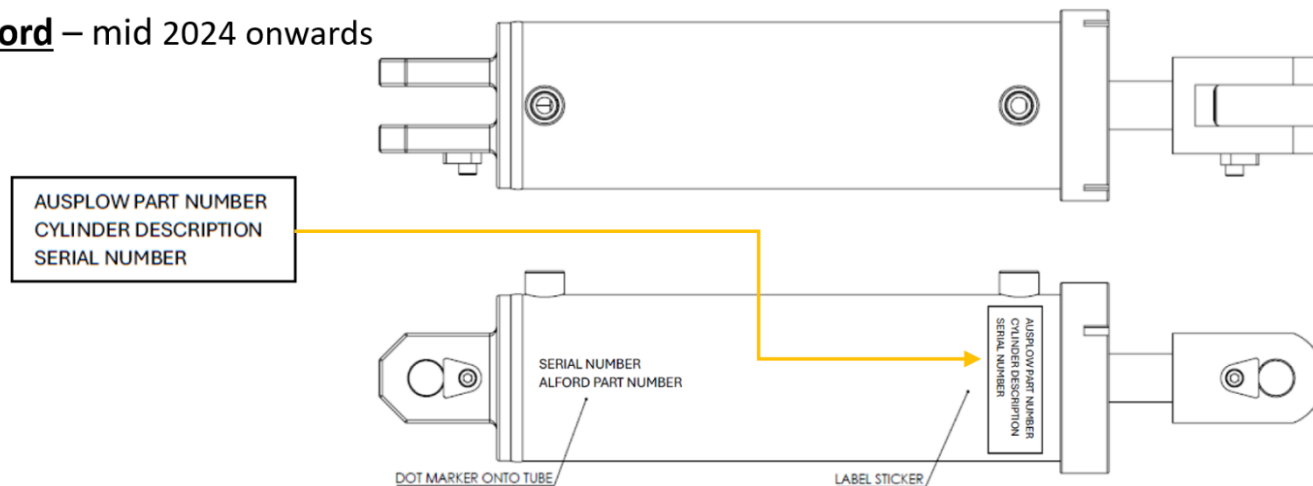



# Easitill & DBS Auseeder

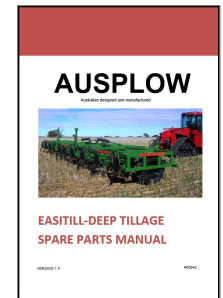
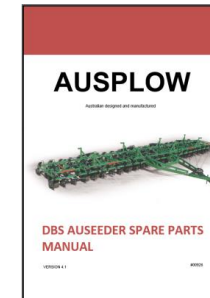

## 1.13 Hydraulic Phasing Cylinders

### Alford – Up to 2009 & **2022 on**

- Date of manufacture or SN
- Ausflow Part No **2022 on**
- Cylinder ID – up to 2009 & between 2022 and early 2024
- Series

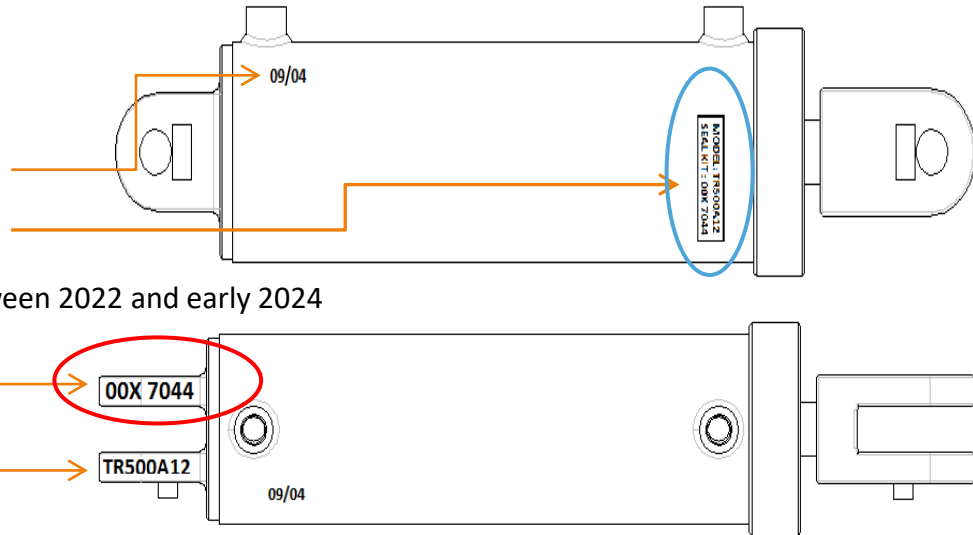

### Baker – 2009 to 2022

- Ausflow Part No
- Size
- Serial number
- Supplier code

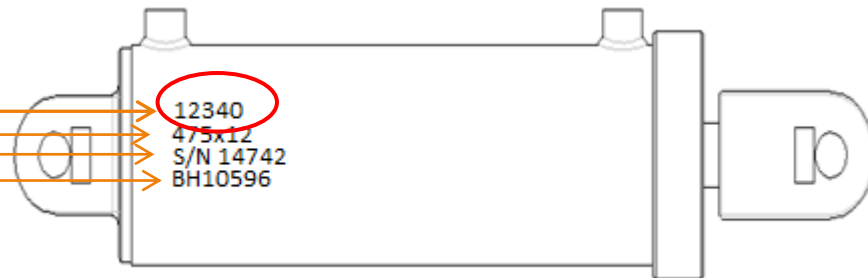



# Easitill & DBS Auseeder

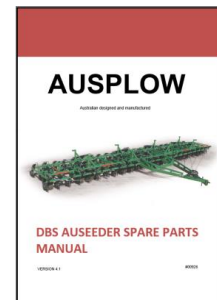

## 1.13 Hydraulic Cylinders - PTE

These were only fitted to the following machines in 2019:

DBS 1447 (Narembreen), DBS 1450 (Moora) & DBS 1463 (Quairading)

These have different seal kits than the standard Baker or Alford Cylinder.

- Ausflow part number
- Size
- Serial number
- Supplier code

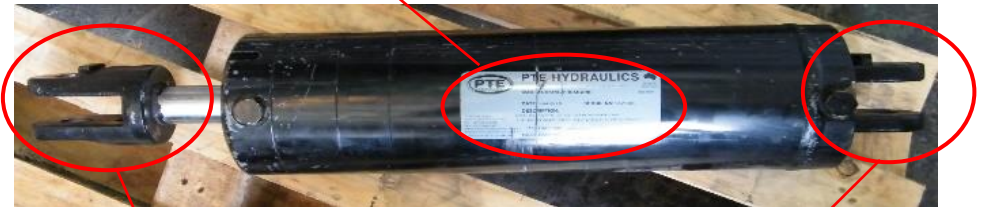







# DBS Auseeder

## 1.14 Cable Stay Kits

Consist of:

- Cables Kits
- Cable Stay Brackets Series II  
(Not interchangeable with Series I,  
Series I brackets avail as spare part)
- Cable Stay Bracket Fasteners  
(now plate and bolt, Series I were U bolts)
- 5 frame bars also have  
Cable Support Kits

Bar Model	Cable Stay Kit	Cable Kit Inner	Cable Bracket	Cable Kit Outer	Cable Support Kit	Cable Bracket Fasteners
260N-32/36	05610 Includes	05622 x2	33755 x1			
260N-42/48	05611 Includes	05624 x2	33755 x1			
300N-32/36	05612 Includes	05623 x2	33759 x1			
300N-40/44	05613 Includes	05626 x2	33759 x1			
D/E260-48/54/60	05615 Includes	05627 x2	33756 x1			
D/E260-59	11413 Includes	11414 x2	33757 x1	11416 x2	05687 x2	
D/E260-64	05616 Includes	05627 x2	33758 x1	05629 x2	05687 x2	
D/E260-70	11092 Includes	05424 x2	33758 x1	05630 x2	05687 x2	
D/E300-43/49/51	05618 Includes	05627 x2	33760 x1			
D300-44/46	05613 Includes	05626 x2	33759 x1			
D300-50	26543 Includes	26547 x2	33761 x1	26546 x2	05687 x2	
D/E300-55	05619 Includes	05625 x2	33762 x1	05628 x2	05687 x2	
D300-60T	05621 Includes	05627 x2	33763 x1	05630 x2	05687 x2	
D/E300-61	05620 Includes	05627 x2	33762 x1	05630 x2	05687 x2	
D381-32	14741 Includes	05424 x2	33757 x1			
D381-48	14657 Includes	05775 x2	33757 x1	05630 x2	05687 x2	

05337 x 2, 09360 x 4, 32754 x 4, 09332 x 4

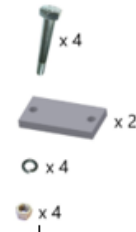

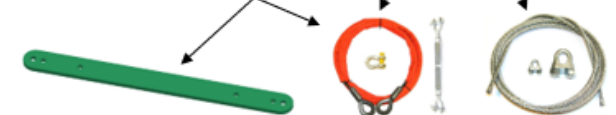



# DBS Auseeder

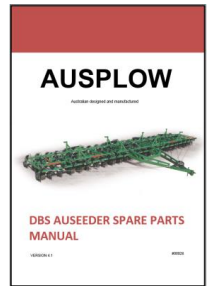

## 1.14 Cable Kits

Consist of:

- Cable  
(length measured eyelet to eyelet)
- Shackle
- Turnbuckle

Part No	Description	Cable	Cable Length	Shackle 05394	Turnbuckle 05376
05622	Cable Kit 5.0m	05631 x 1	4.08m	x 1	x 1
05623	Cable Kit 5.3m	05632 x 1	4.47m	x 1	x 1
26547	Cable Kit 5.37m	26548 x 1	4.54m	x 1	x 1
05624	Cable Kit 5.45m	05633 x 1	4.62m	x 1	x 1
05625	Cable Kit 5.55m	05634 x 1	4.72m	x 1	x 1
11093	Cable Kit 5.75m	05418 x 1	4.97m	x 1	x 1
11414	Cable Kit 5.67m	11415 x 1	4.84m	x 1	x 1
05626	Cable Kit 5.85m	05635 x 1	5.02m	x 1	x 1
05424	Cable Kit 5.95m	05419 x 1	5.12m	x 1	x 1
05627	Cable Kit 6.05m	05636 x 1	5.22m	x 1	x 1
05775	Cable Kit 6.32m	05776 x 1	5.49m	x 1	x 1
26546	Cable Kit 7.53m	26545 x 1	6.70m	x 1	x 1
11416	Cable Kit 7.55m	11417 x 1	6.71m	x 1	x 1
05628	Cable Kit 7.85m	05637 x 1	7.02m	x 1	x 1
05629	Cable Kit 8.0m	05638 x 1	7.17m	x 1	x 1
05630	Cable Kit 8.60m	05639 x 1	7.77m	x 1	x 1

Note:

The **Cable Kit** length is Overall length that includes shackle & turnbuckle





# DBS Auseeder

## 1.15 DBS Wheel Hubs

- 80 Series Hub
- Parts sold individually or complete assembly # 01086
- Check Dust Cap for 80 marking
- Older bars had FAD stamping with different bearings and seals

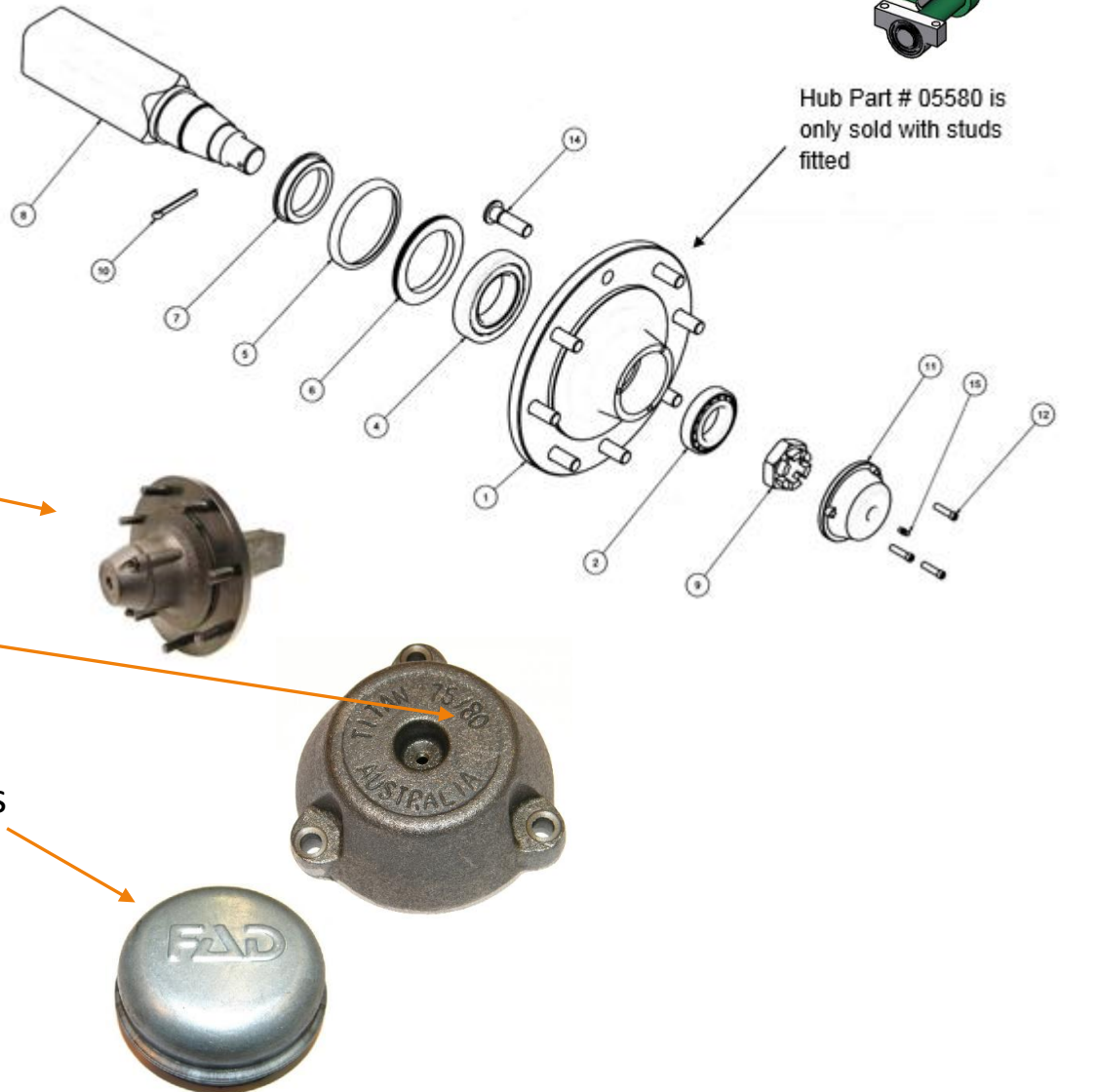



# DBS Auseeder

## 1.16 Stability Wheel Kits

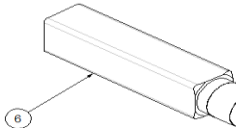
- One LH and RH assembly in kit #16059
  - **Not the same hub as DBS**
  - HD 50 series Hub parts
  - Used for reducing  
“Wind Up”
- 
- A technical line drawing of a hub assembly, showing a rectangular housing with a central shaft. A callout line with a circle containing the number '6' points to a specific feature on the side of the housing.

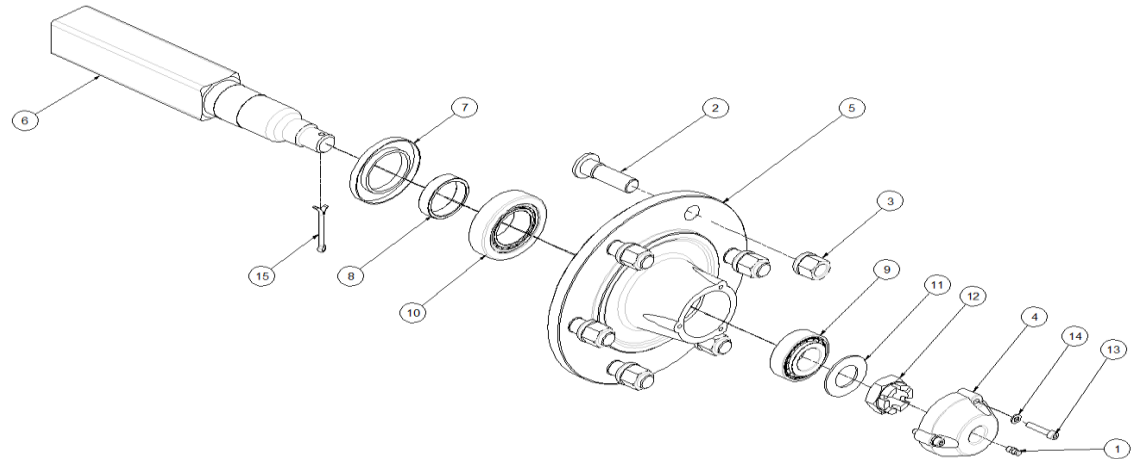



# DBS Auseeder

## 1.17 Sectional Control - Granular

Ausplow has developed retrofit kits for existing Multistream carts. Upgrading to a granular and liquid sectional control capability for improved uniformity and reduced product overlap generating input cost savings whilst seeding. Requires X35 Topcon system.

The system can also be adapted to suit other makes of Aircarts with a Class A type air system and operating in similar manner to the Ausplow Multistream.

- ▶ The granular system has electronically controlled actuator units mounted on top of the primary seed and fertiliser standpipes which can control either 4, 6 or 8 sections depending on the air kit configuration.
- ▶ The electric actuators operate slide valves which cut off supply of granular product to the respective secondary heads.

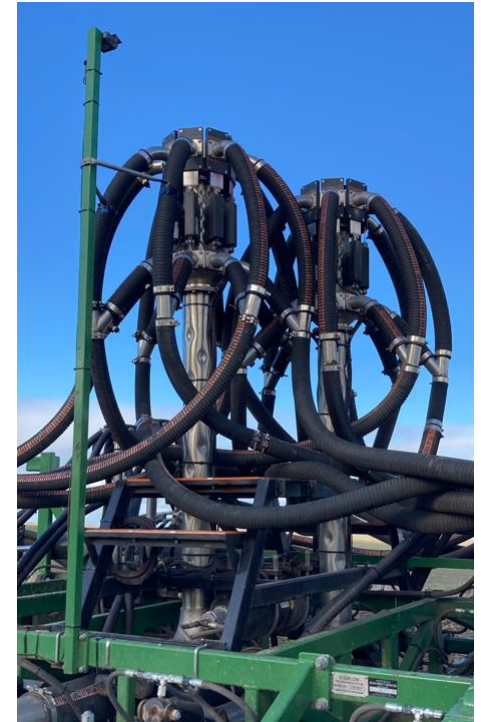



# Part 2 – Easitill / Deep Tillage

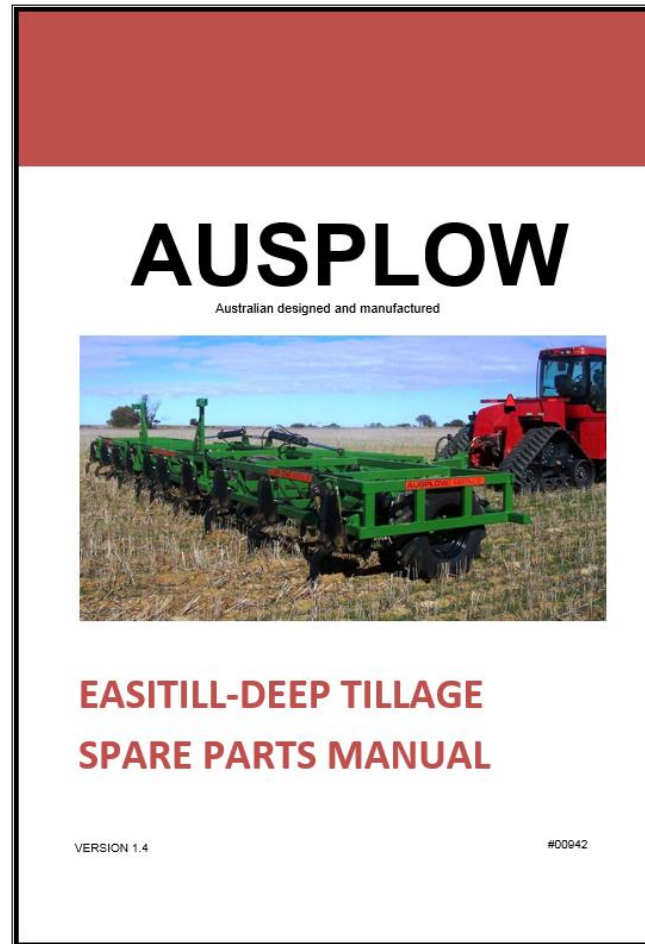



# Easitill / Deep Tillage

## 2.1 Deep Tillage – Evolution

**DEEP RIPPER**  
(1991-98)

**EASITILL I**  
(1998-2005)

**EASITILL II**  
(2006 on)

Ausplow Rigid  
Limited Parts Available

Ausplow Hydraulic  
Limited Parts Available

Easitill Rigid  
Limited Parts Available

Easitill Hydraulic I & II

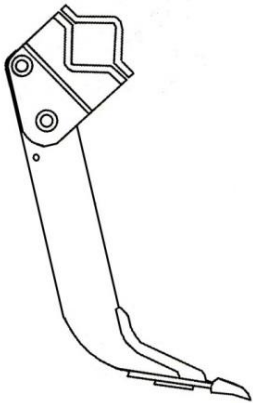



# Easitill / Deep Tillage



## 2.2 Parts Availability for Older Tines

### □ Ausplow Rigid

- Dura Blade
- Shin guard
- Shear pin/bolt
- Current clamp plate

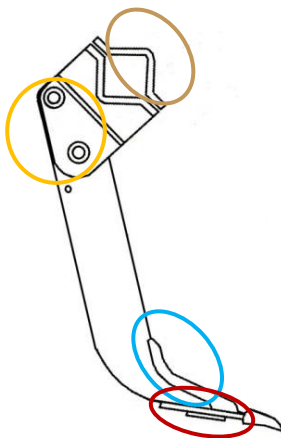

### □ Ausplow Hydraulic

- Dura Blade
- Shin guard
- Hydraulic cylinder
- Pin sets
- Current clamp plate

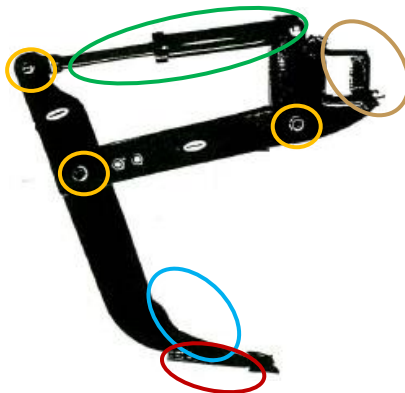

### □ Easitill Rigid

- Dura Blade
- Current shank guard
- Shear pin /bolt
- Current clamp plate

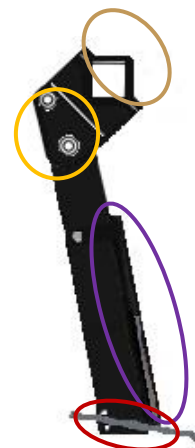



# Easitill / Deep Tillage



## 2.3 Easitill V1 and V2 Shanks

Easitill V1 shank 750mm

- ❑ 1998-2005
- ❑ #02070

Easitill V2 shank 750mm

- ❑ 2006 on
- ❑ #02217





# Part 3 – Multistream Airseeders

**Tow Between**



**Tow Behind**



**Drawbar Mount**



**Compact**

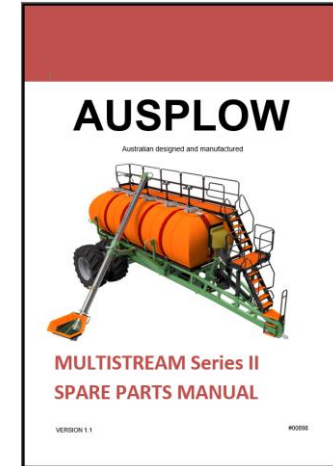

**SERIES II**  
Multistream  
2018 on

**SERIES I**  
Multistream

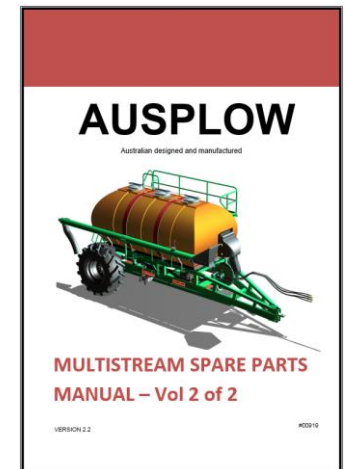
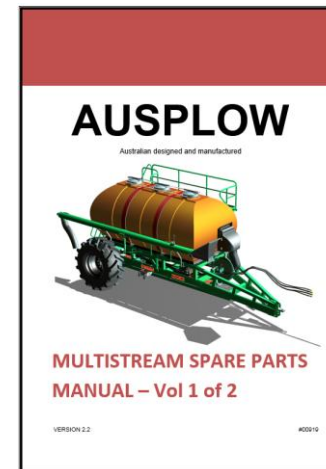



# Multistream Airseeders

## 3.1 Front Axles and Hubs

- Dolly Front Axle – TBH
- Steering Front Axle – TBH

**Now upgraded with Steerer Upgrade kit**

➤ 100 or 110 series Hubs

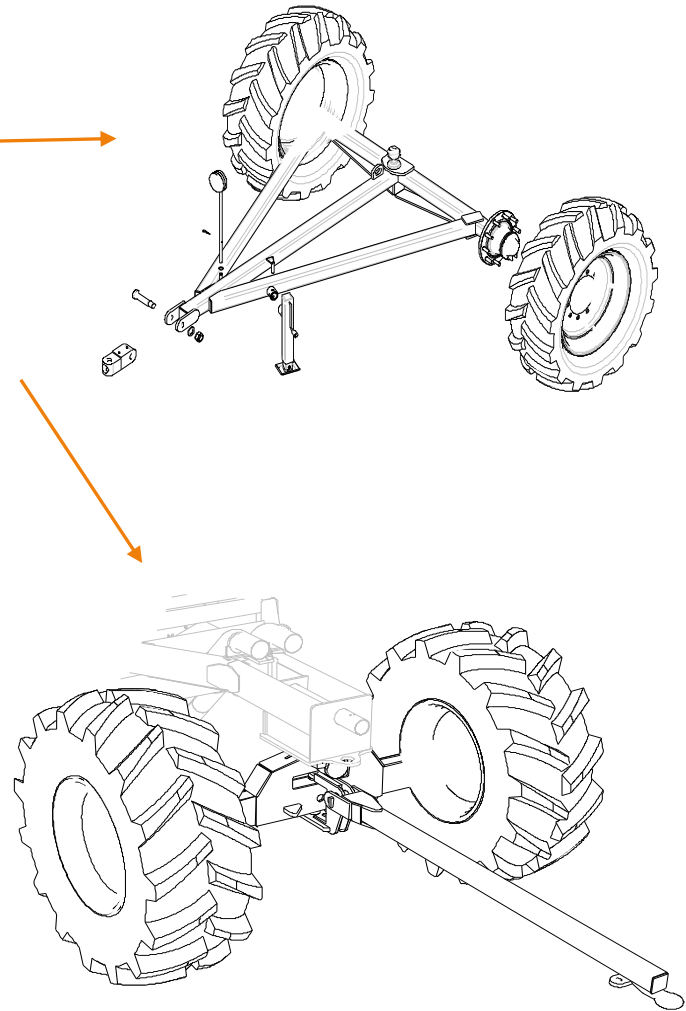
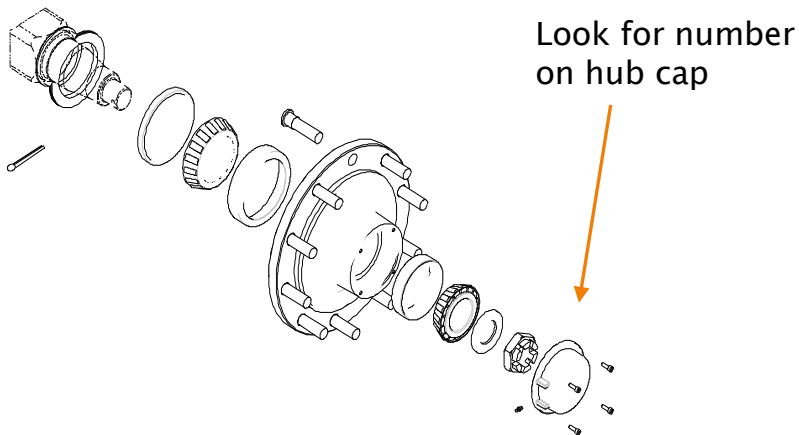



# Multistream Airseeders

## 3.1 Steerer Upgrade Kit

- Parts Bulletin 5-19
- Improve durability
- Bigger 60mm Tow Pin (was 40mm)
- Pull Yoke now 60mm pin
- Drawbar 60mm pin
- Two kits at reduced price:

### #16078

MS Steerer Upgrade Kit –  
Suit M30 Tie Rods

### #16079

MS Steerer Upgrade Kit –  
Suit M25 Tie Rods

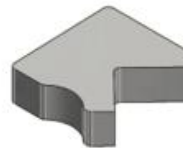
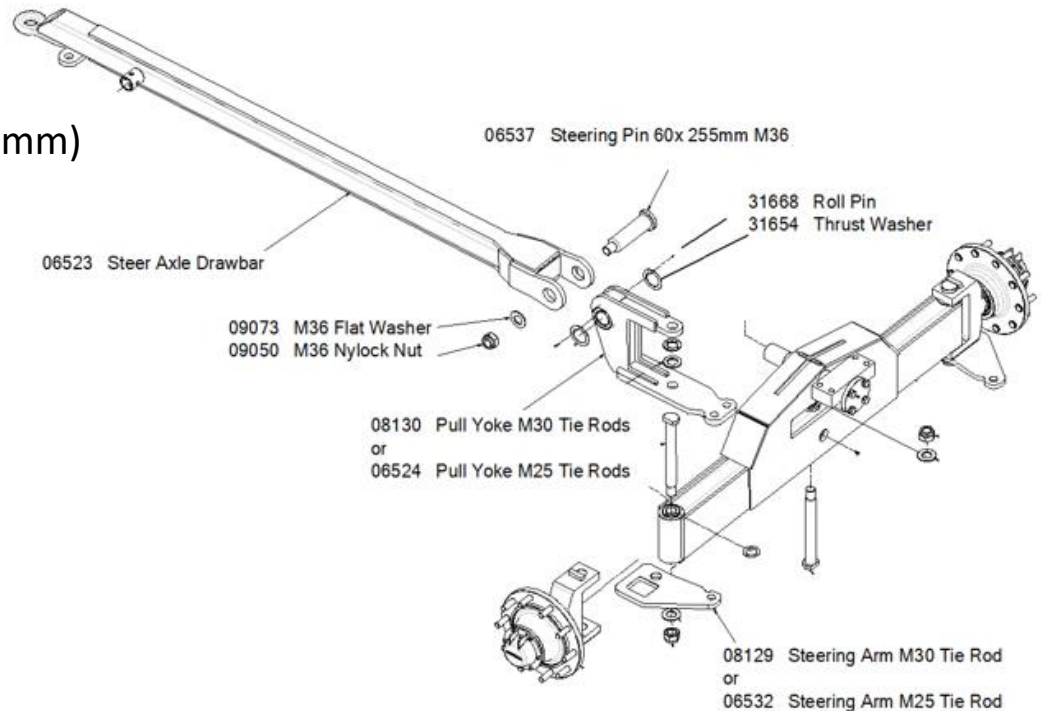

30664 Steerer Front Axle Stopper

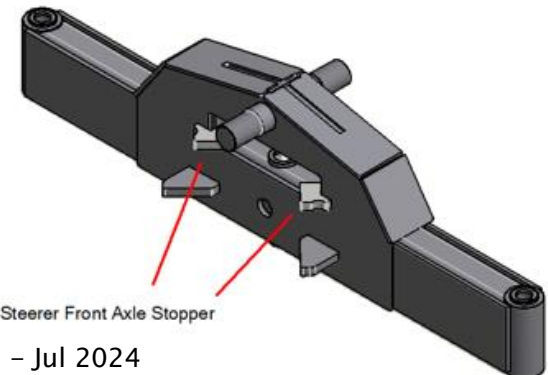

30664 Steerer Front Axle Stopper



# Multistream Airseeders

## 3.1 Rear Axles

- Rear Axles Series I

- 100, 110 or 150 series Hubs

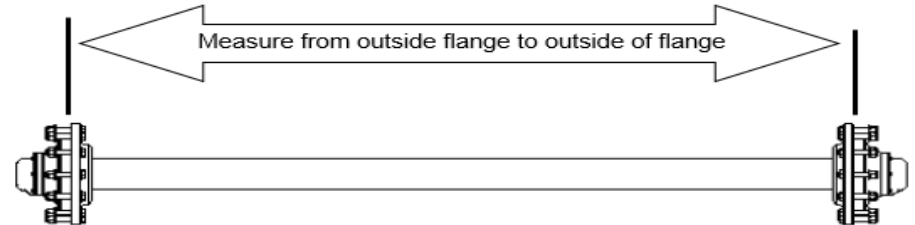

- Rear Axles Series II

- 150 series Hubs, or
- 110 Series

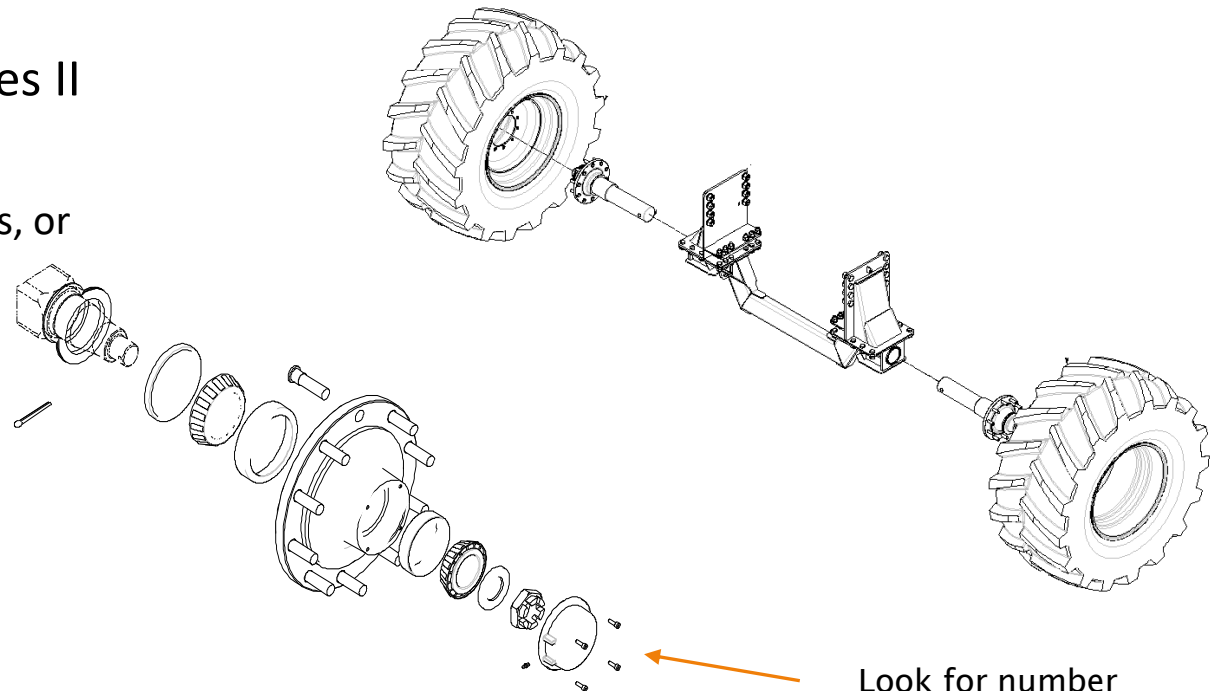

Look for number  
on hub cap

Version 3 - Jul 2024



# Multistream Airseeders

## 3.2 Hydraulic Filters

Mahle Hydraulic Filter Assembly - **Obsolete**

Hydraulic Filter Element – Stauff (# 04095)



Hydac 110 Filter Assembly – HP/HC - **Obsolete**

Hydraulic Filter Element – 110 (# 04108)

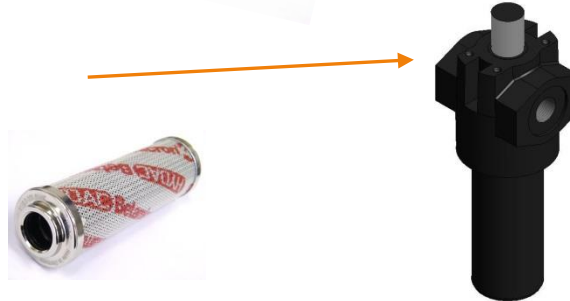

### CURRENT

Hydac/Stauff Filter Assembly – 160 (#07564)  
c/w 04204 Filter element

Hydraulic Filter Element- Hydac160  
(# 04204)





# Multistream Airseeders

## 3.3 Heater Exchangers



CURRENT



Core size 11

2001 - 2002

#07011- Heat Exchanger

Size approx: Core 11 - 330wx400h mm  
Core 23 - 480wx545h mm

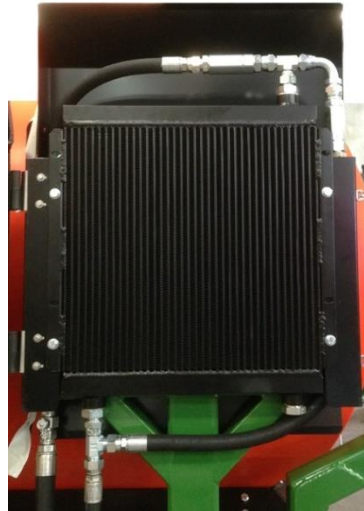

Core size 23

2003 - 2013

with external bypass

Superseded



Core size 23 with internal bypass

2014 onwards

#27106 – Heat Exchanger

#15768 – Heat Exh Upgrade Kit

(heat exchanger with hoses & fittings)

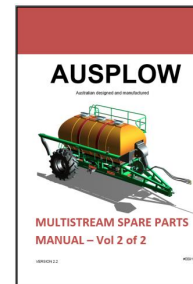



# Multistream Airseeders

28912

Small Seed Tank Funnel

## 3.4 Tank Lids

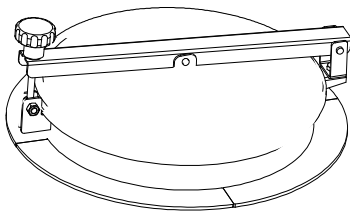

Version 1  
Released 2001  
**Obsolete**

Tank Lid Seals:  
Diameter:

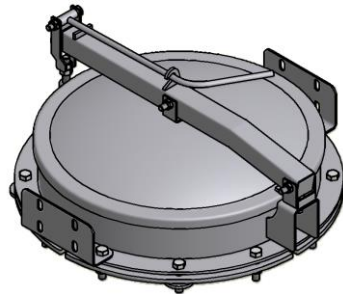

Version 2  
Released 2005  
**NLA- some parts are**

#11505 (glue on)  
465mm

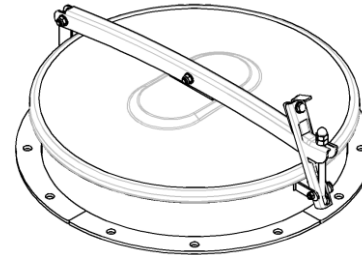

Version 3  
Released 2011/12

#15055  
450mm



**CURRENT**

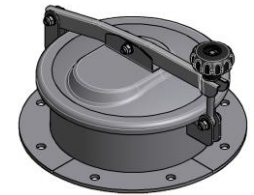

Small Seed  
Released 2012

#14294  
223mm



# Multistream Airseeders

## 3.5 Tanks

2000Ltr End/Middle Tank

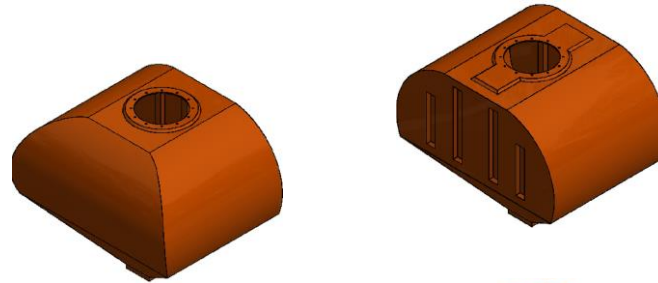

3000Ltr End/Middle Tank

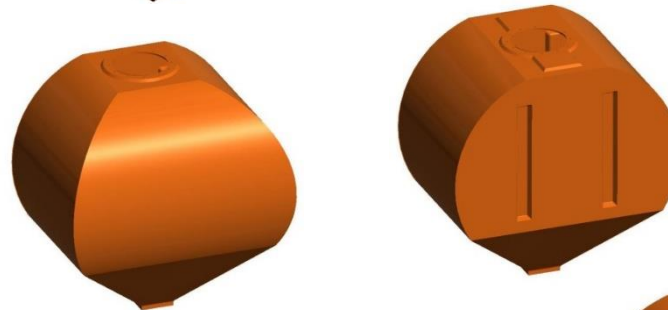

4500Ltr End/Middle Tank

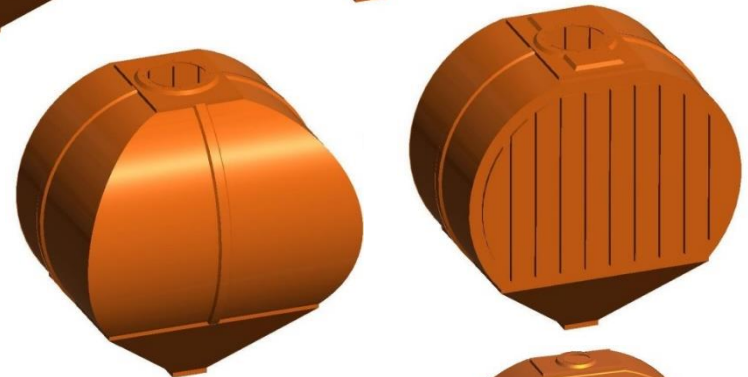

1500Ltr Small Seeds Tank





# Multistream Airseeders

## 3.5 Tank/Metering Unit Bolts

- ▶ Captive nuts were fitted in tanks from Dec 2016 (MS506)
- ▶ M10x25mm bolts #09948 & washers #09810 are now used instead of M12 bolts
- ▶ If fitting new metering units to the older M12 bolted tank, drill out metering unit holes to 13mm and use #09133 M12 x 40mm SS Bolt and #09108 SS M12 washer
- ▶ If fitting an older metering units to the new tank, use M10x25mm bolts #09948 & washers #09810 as well as the original #09108 SS M12 washer

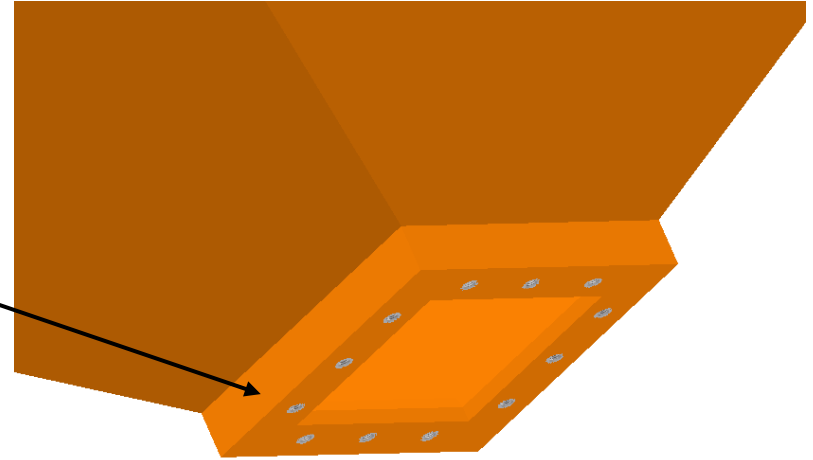



# Multistream Airseeders

## 3.6 Metering Unit Assemblies

- Metering Unit V3.5/V4  
(Obsolete, parts NLA)
- **Double Shoot** Metering Unit **V5** – 5" or 6"
- **Single Shoot** Metering Unit **V5** – 5" or 6"

Note: Supplied with Proximity sensor with Deutsch fitting. Check plug fitting is correct!

If Packard plug required make a note in the sales order

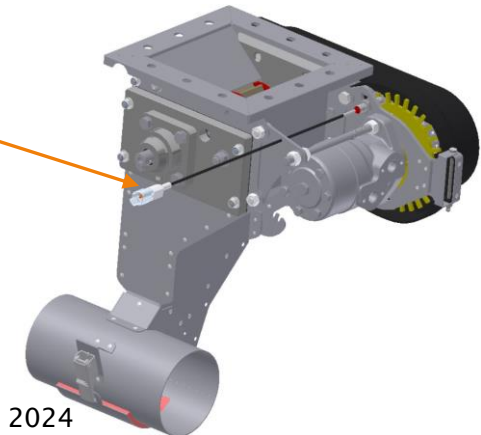
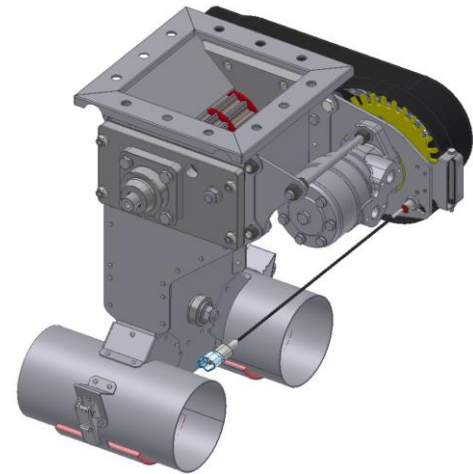
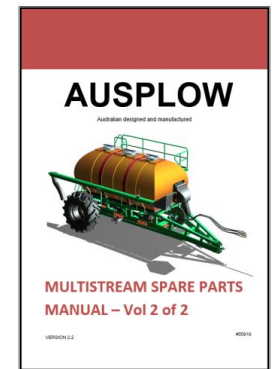
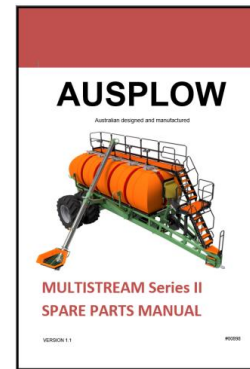



# Multistream Airseeders

## 3.6 Metering Unit Parts

- Fertiliser Metering Wheel



- Seed Metering Wheel



- Small Seed Metering Wheel



- Metering Wheel Spacers – Now only 6mm nylon type



- Hydraulic motor OMR200 is used for Seed

- OMR100 for Fertiliser



Smaller  
pump head



Larger  
pump head

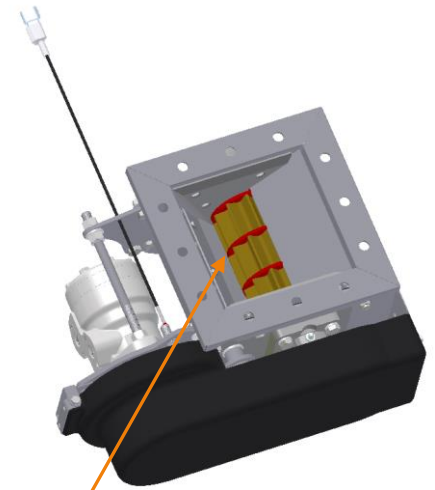



# Multistream Airseeders

## 3.6 Metering Unit Bearing Assy

### ❖ Current Type

- Same Bearing as older type
- Same Seals as older type
- Complete Assy #27066

### ❖ Older Type (Pre 2015)

- Replaced by #27066

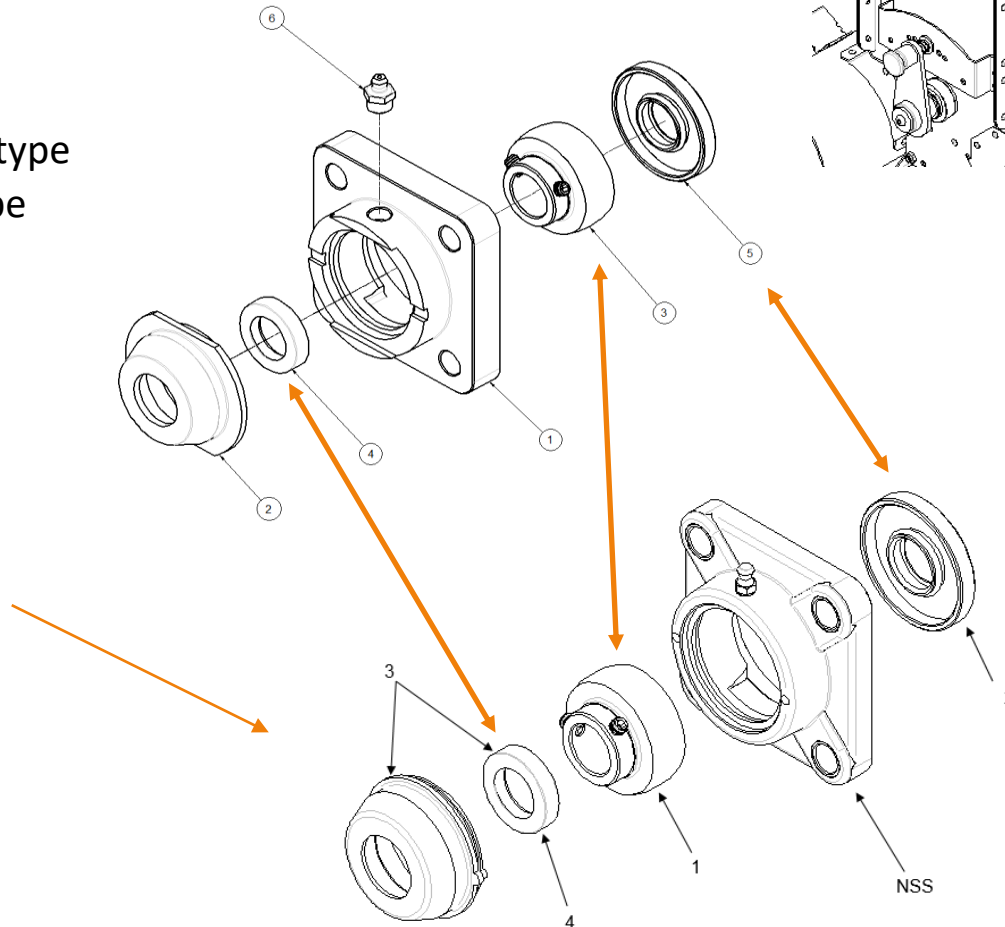



# Multistream Airseeders

## 3.6 Metering Unit Divider Flap

### ❖ Current Type (2022 on)

- Uses same seals & bearing as older type
- Dividing Flap now steel for longer life
- Dividing Flap # 34136
- Dividing Flap Shaft # 34131
- Not interchangeable with older type

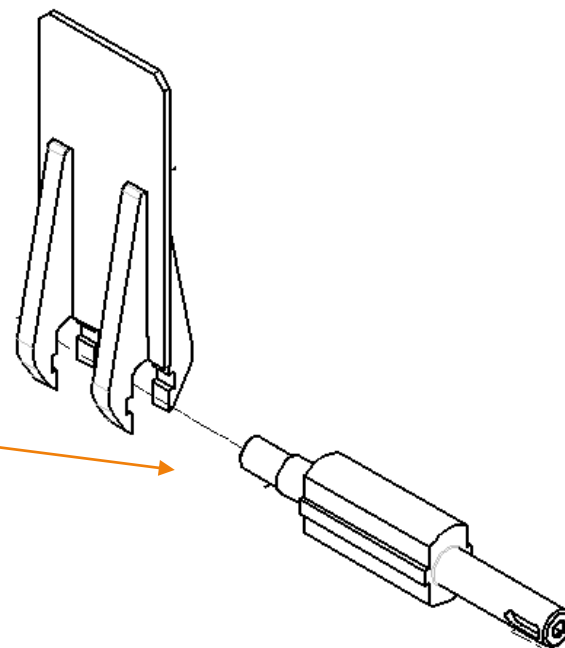

### ❖ Older Type

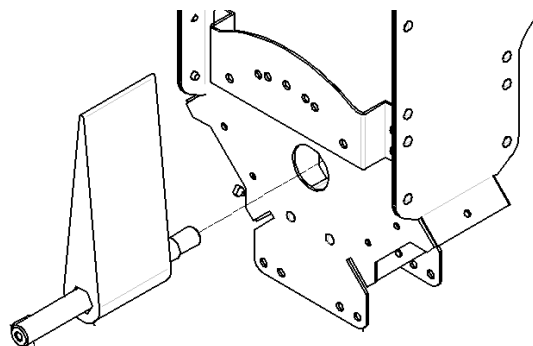



# Multistream Airseeders



## 3.6 Metering Unit Chains & Sprockets

The slow speed drive kit (Part # 08885) is recommended for machines of less than 13 meters width sowing small seeds at rates of less than 4kg/ha.

Item #	Qty	Description	Part # Seed	Part # Fertiliser	Part # Slow Speed
ALL	1	KIT, SLOW SPEED DRIVE			08885
1	1	CHAIN WITH MASTER LINK	08098	08099	08883
2	1	SPROCKET MOTOR (DRIVE)			
		17 TEETH	07468		
		20 TEETH		07469	
		13 TEETH			08843
3	1	SPROCKET SHAFT (DRIVEN)			
		38 TEETH	07471		
		20 TEETH		07469	
		45 TEETH			08844
4		MASTER LINK	08094	08094	08094



# Multistream Airseeders

## 3.7 Camera Systems

❖ Camera Kits – 4,6,8,10,12

❖ Eg 8 Camera Kit #04592

Consists of:

2 x 7" Monitors

8 x Ball Cameras

– 4 for tanks, 4 for meters

❖ **NOTE:**

**03275, 15429 & 15718 are not interchangeable with older PV harness monitor (old type)**

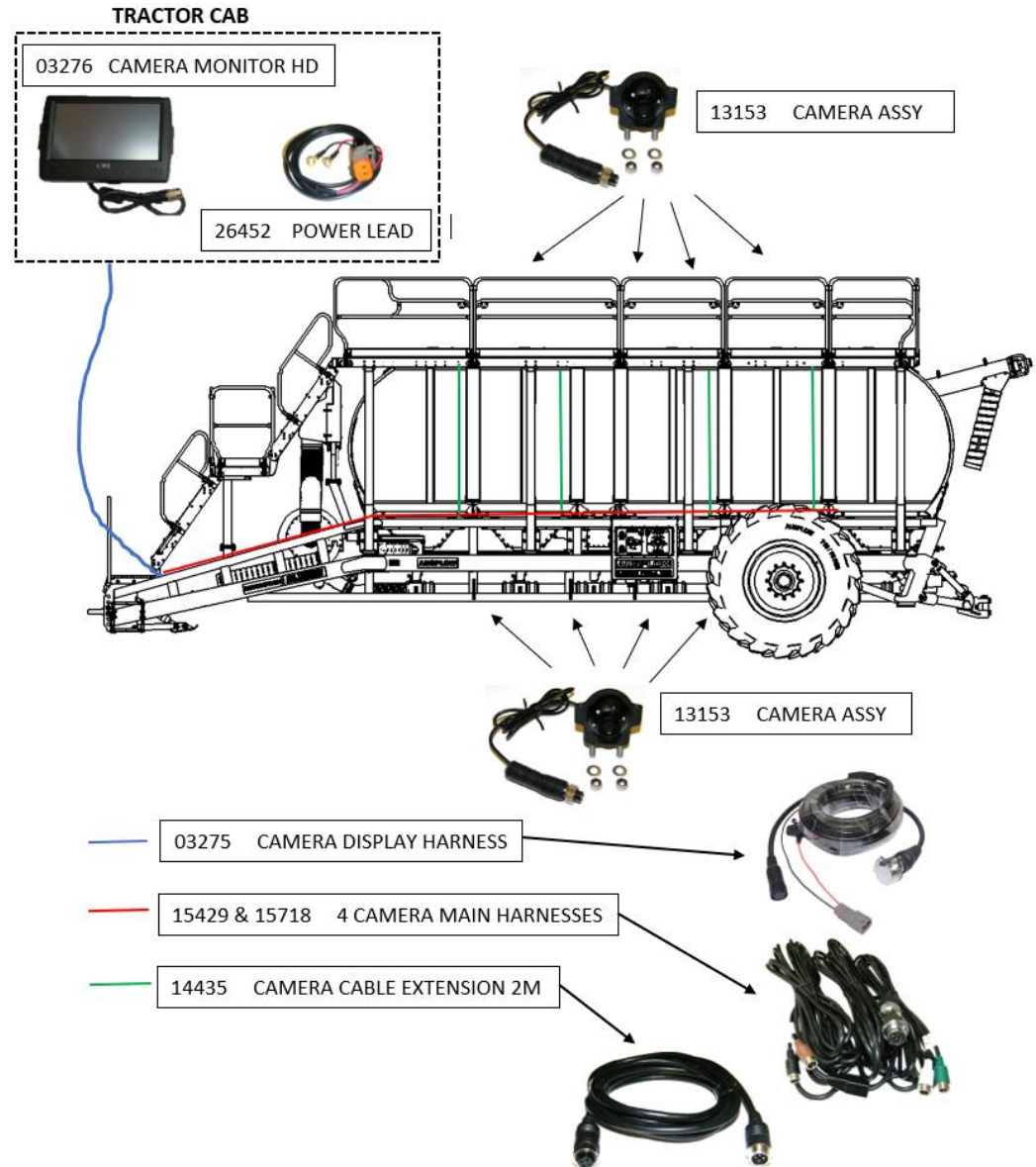



# Multistream Airseeders

## 3.7 Camera Systems

- ❖ Camera Kits listed in manual



GRANULAR				
Bin	# Bins	Configuration	Meter Unit Cameras	Tank Cameras
A6000 DB	2	2G	2	2
A9500 BT	2	2G	2	2
A9500 BH*	2	2G	2	2
A11000 BT	3	3G	3	3
A11000 BH*	3	3G	3	3
M6000 DB	3	3G	3	3
M9000 BT	3	3G	3	3
M9000 BH*	3	3G	3	3
M14000 HD BT	3	3G	3	3
M14000 HD BH*	3	3G	3	3
M12000 BT	4	4G	4	4
M12000 BH*	4	4G	4	4
M15000 HD BT	4	4G	4	4
M15000 HD BH*	4	4G	4	4
M18000 HD BT	4	4G	4	4
M19500 HD BT	5	5G	5	5
M22000 HD BT	5	5G	5	5
M24000 HD BT	6	6G	6	6

LIQUID				
Bin	# Bins	Configuration	Meter Unit Cameras	Tank Cameras
M6000 DB	3	2G1L	2	2
M9000 BT	3	2G1L	2	2
M9000 BH*	3	2G1L	2	2
M14000 HD BT	3	2G1L	2	2
M14000 HD BH*	3	2G1L	2	2
M12000 BT	4	3G1L	3	3
M12000 BH*	4	3G1L	3	3
M15000 HD BT	4	3G1L	3	3
M15000 HD BH*	4	3G1L	3	3
M18000 HD BT	4	3G1L	3	3
M19500 HD BT	5	4G1L	4	4
M22000 HD BT	5	4G1L	4	4
M24000 HD BT	6	5G1L	5	5
M27000 HD BT	6	5G1L	5	5
M28000 HD BT	7	6G1L	6	6

Code	Camera Configurations
04591	4 camera system (7" LCD quad splitting monitor, 4 ball cameras, 8 channel connector & loom)
04580	6 camera system (2x7" LCD quad splitting monitor, 6 ball cameras, 8 channel connector & loom)
04592	8 camera system (2x7" LCD quad splitting monitor, 8 ball cameras, 12 channel connector & loom)
04581	10 camera system (3x7" LCD quad splitting monitor, 10 ball cameras, 12 channel connector & loom)
04593	12 camera system (3x7" LCD quad splitting monitor, 12 ball cameras, 16 channel connector & loom)



# Multistream Airseeders

## 3.7 Camera Mounting



Tank camera



Metering camera



Behind Multistream  
(Optional)





# Multistream Airseeders

## 3.8 Air Delivery Tube Connectors

All 5" and 6" air tubes are now in Stainless Steel

- Old versions used rubber connectors with T-Bolts
- Old versions used Lap Clamps
- Current - Hump Couplers with T-Bolts
- Note: SS Delivery tubes are a different length to current ones using Hump Couplers if Lap Clamps or Rubber hose connectors are used





# Multistream Airseeders

## 3.8 Air Kit – Primary

- ❖ SS Stand Pipes 5" or 6"
- ❖ SS Single Flange Air Tubes
- ❖ 5" or 6" Rubber Air Hose
- ❖ Support Brackets and Pri Head

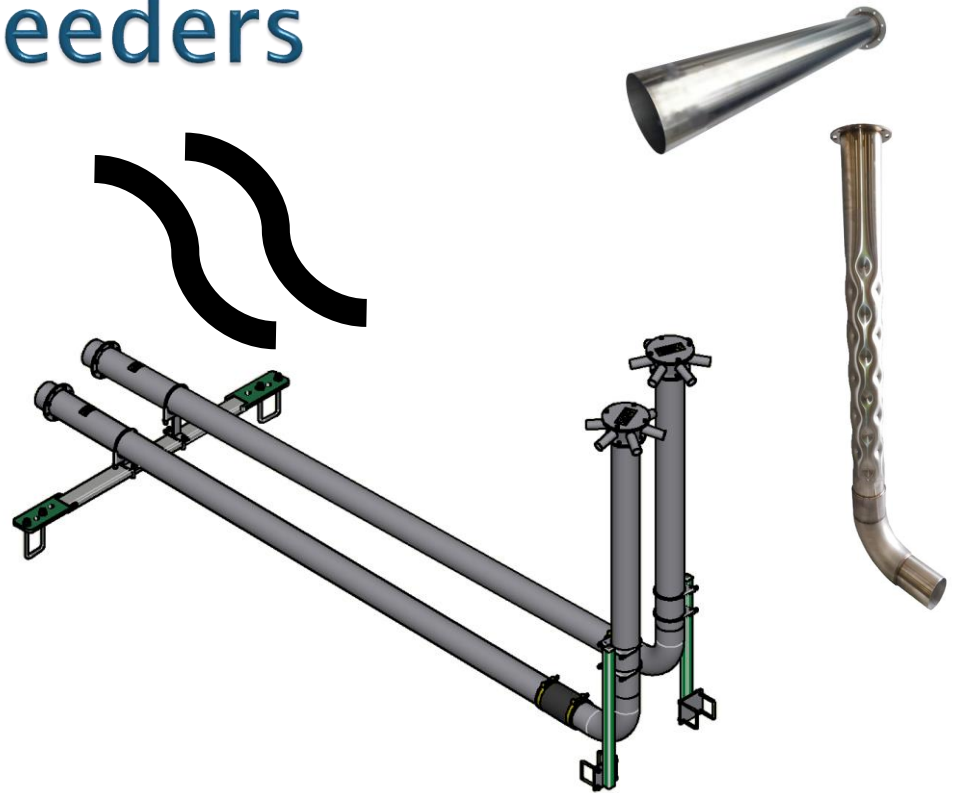

## ❑ Air Pac – Secondary

- ❖ SS 2.5" Secondary Standpipe
- ❖ 32 and 63mm Rubber Air Hose
- ❖ Hose Supports and Sec Heads
- ❖ Do not call these Air Kits

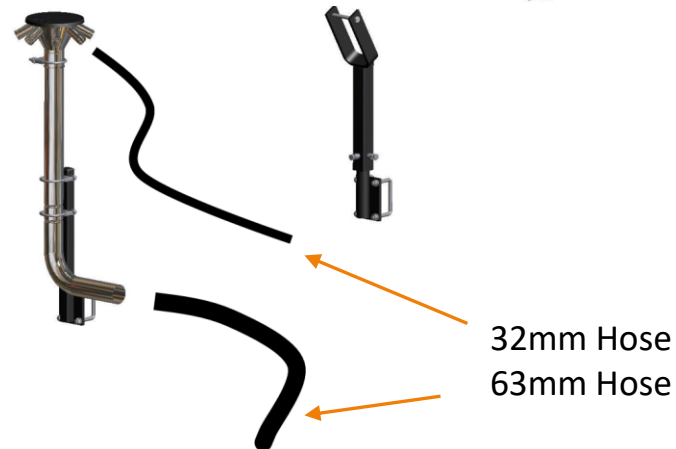



# Multistream Airseeders

## 3.8 Air Kit – Primary

- ❖ Tow behind or Tow between.
- ❖ 5" or 6"
- ❖ Double shoot or Single shoot.
- ❖ See table in Air kit spare parts manual

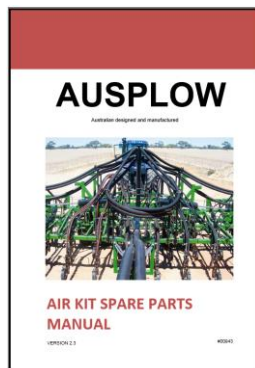

Primary Air Kits for DBS Bars							
5" AIR KITS							
Multistream	PRIMARY HEAD RISER		SINGLE SHOOT		DOUBLE SHOOT		No of Runs
	Tow Between	Tow Behind	Tow Between	Tow Behind	Tow Between	Tow Behind	
<b>DBS Bar</b>							
D260-24	28881	28453	16310	16298	16305	16292	4
D260-28	28881	28453	16310	16298	16305	16292	4
D260-32	28881	28453	16310	16298	16305	16292	4
D260-36	28881	28453	16310	16298	16305	16292	4
D260-42	28881	28453	16310	16298	16305	16292	4
D260-48E	28881	28453	16310	16298	16305	16292	4
D260-48N	28881	28453	16311	16299	16306	16295	6
D260-54	28881	28453	16311	16299	16306	16295	6
D260-59	28881	12360	16311	16300	16306	16296	6
D260-64	28881	28453	16311	16299	16306	16295	6
D260-70	28881	28453	16311	16299	16306	16295	6
D300-32	28881	12360	16310	16349	16305	16294	4
D300-36	28881	12360	16310	16349	16305	16294	4
D300-40	28881	12360	16310	16349	16305	16294	4
D300-44	28881	12360	16310	16349	16305	16294	4
D300-46	28881	12360	16311	16300	16306	16296	6
D300-48	28881	12360	16311	16300	16306	16296	6
D300-49	28881	12360	16311	16300	16306	16296	6
D300-50	28881	12360	16311	16300	16306	16296	6
D300-51	28881	12360	16311	16300	16306	16296	6
D300-55	28881	12360	16311	16300	16306	16296	6
D300-60T	28881	12360	16311	16300	16306	16296	6
D300-61	28881	12360	16311	16300	16306	16296	6
D381-28	14418	12360	16362	16349	16364	16294	4
D381-32	14418	12360	16362	16349	16364	16294	4
D381-36	14418	12360	16362	16349	16364	16294	4
D381-40	14418	12360	16363	16300	16365	16296	6
D381-44	14418	12360	16363	16300	16365	16296	6
D381-48	14418	12360	16363	16300	16365	16296	6

6" AIR KITS							
Multistream	SINGLE SHOOT		DOUBLE SHOOT				No of Runs
	Tow Between	Tow Behind	Tow Between	Tow Behind	Tow Between	Tow Behind	
<b>DBS Bar</b>							
D260-48N	28886	28662	03115	16550	16467	16548	6
D260-48E	28886		03115		16467		6
D260-54	28886	28662	03115	16550	16467	16548	6
D260-59	28791	28662	16319	16550	16315	16548	6
D260-64	28886		03115		16467		6
D260-70	28886	28662	16320	16551	16316	16302	8
D300-61	28791	26419	16319	16359	16315	16301	6
D300-61	28791		16345		06072		8
D300-46	28791		16319		16315		6
D300-40	28791	26419	16319	16359	16315	16301	6
D300-60T	28791	26419	16319	16359	16315	16301	6



# Multistream Airseeders

## 3.8 New Evolution Air Delivery Hose

New Release Jan 2022



This high-quality hose has special ribbing on the outside to improve its bend radius making it easier to install and less prone to hose collapse when bent.

Parts Bulletin 9-21 refers:

- ▶ #10810 Hose Rubber EVO 63mm (2.5") – order as **20m or 40m** etc
- ▶ #10811 Hose Rubber EVO 127mm (5") – order as **10m or 20m** etc
- ▶ #10812 Hose Rubber EVO 154mm (6") – order as **10m or 20m** etc

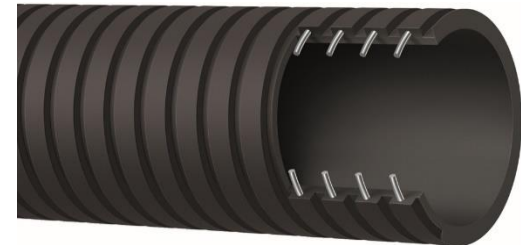
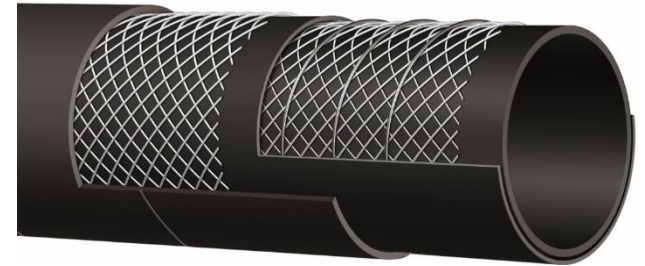



# Multistream Airseeders

## 3.8 Evolution (EVO) Air Seeder Hose

- #10810 EVO hose replaces #10858 - 63mm rubber air hose
- #10811 EVO hose replaces #10859 – 5” rubber air hose
- #10812 EVO hose replaces #10863 – 6” rubber air hose
  
- #10857 – 32mm rubber air hose unchanged



### PLEASE NOTE:

When ordering 32mm and 63mm hose - enter 20mtr, 40mtr, etc.

When ordering 5” and 6” hose - enter 10mtr, 20mtr etc.



# Multistream Airseeders

## 3.8 FloFlex Air Delivery Hose 32mm - Plastic Type

- 32mm Air delivery hose sold in **20mtr rolls (order 20, 40 .... etc).**
- Lighter and improved flow
- Black for seed, orange for fertiliser
- Herbie hose clamp used.





# Multistream Airseeders

## 3.9 Typical Conversions

### □ Information required for quoting conversions:

- **Machine Serial Number** – MS???
- **Machine Controller** - John Deere, Trimble, Topcon X20 or X30/35
- **Current configuration** – eg: 5", 2 granular, 1 rear liquid.
- **Brief description** of the intended conversion – eg: convert liq bin to granular
- **Supplying pictures** can help with identifying parts required.





# Multistream Airseeders

## 3.9 Typical Conversions

### Liquid to Granular Conversion

- Replace liquid sump with Metering Unit  
5" or 6"      Single or Double Shoot      Seed or Fert  
Specify if Proximity Sensor on Meter unit has Deutsch or Packard fitting
- Remove tank vent and overflow pipes, fit end caps
- Add bin basket, supports & hump couplers

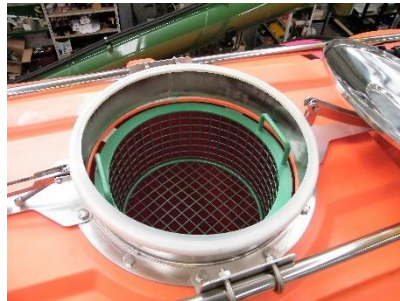
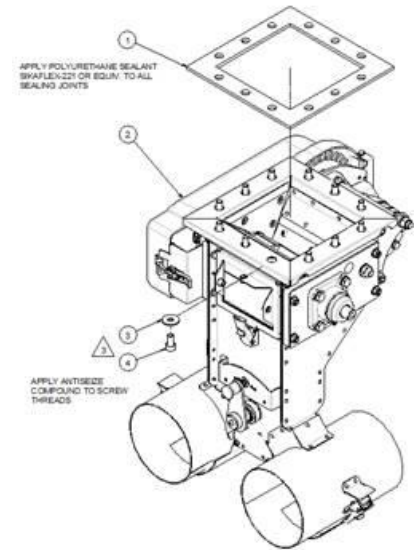



# Multistream Airseeders

## 3.9 Typical Conversions

### Granular to Liquid Conversion – Series I

- Replace Metering Unit
- Fit a Retro Liquid Kit – CP800 pump
  - Contains Sump, Fill, Cal Station
- Need to email us: Type of Controller, Size of tank sump bolts & loom end plug type (Packard or Deutsch)
- Remove bin basket and supports
- Add tank vent and overflow pipes
- Add end tank support strap assy (may need bracket)
- Add longer steel 5" or 6" air delivery tubes

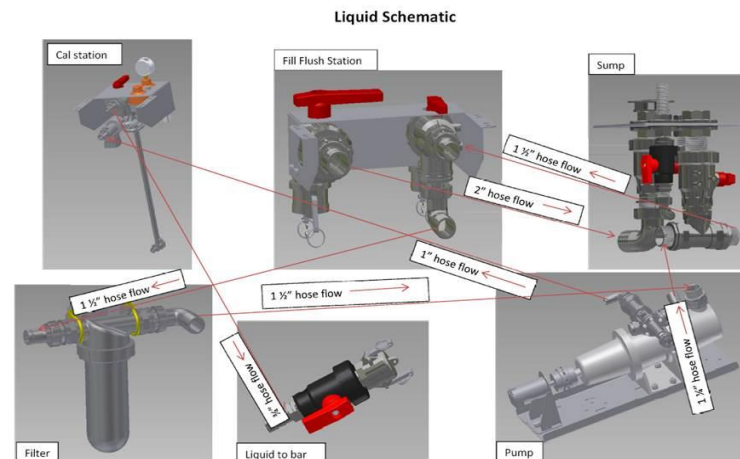

### Granular to Liquid Conversion – Series II

- Uses Liquid Panel, sight glass, sump & fill line

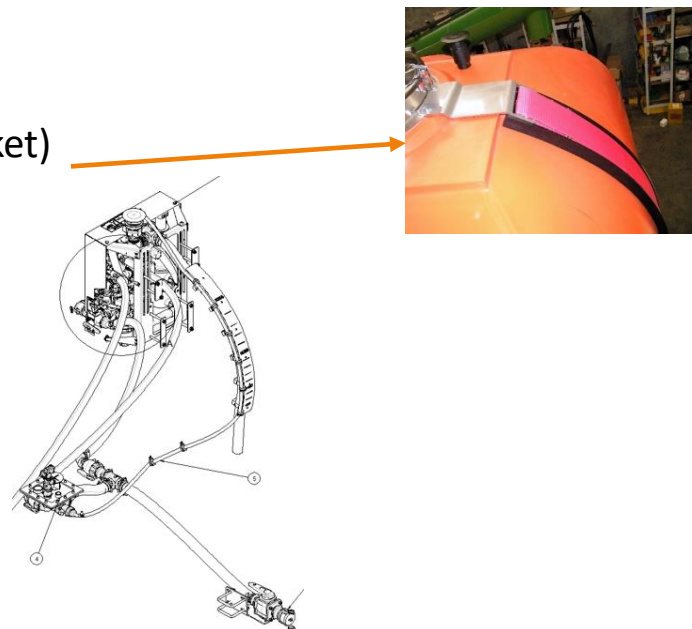



# Multistream Airseeders

## 3.9 Typical Conversions

### Liquid Agitation Kit – for Series I

- One Kit for Tow Between #04491
- One Kit for Tow Behind Bins #04492
- Kit contains:
  - Sump Nozzle Assembly
  - Hydraulic Hoses and fittings to Tractor Hydraulics
  - Pump CP800 Assembly
- Liquid Agitation Kit – for Series II
- Part of Liquid Panel uses Xmas tree configuration

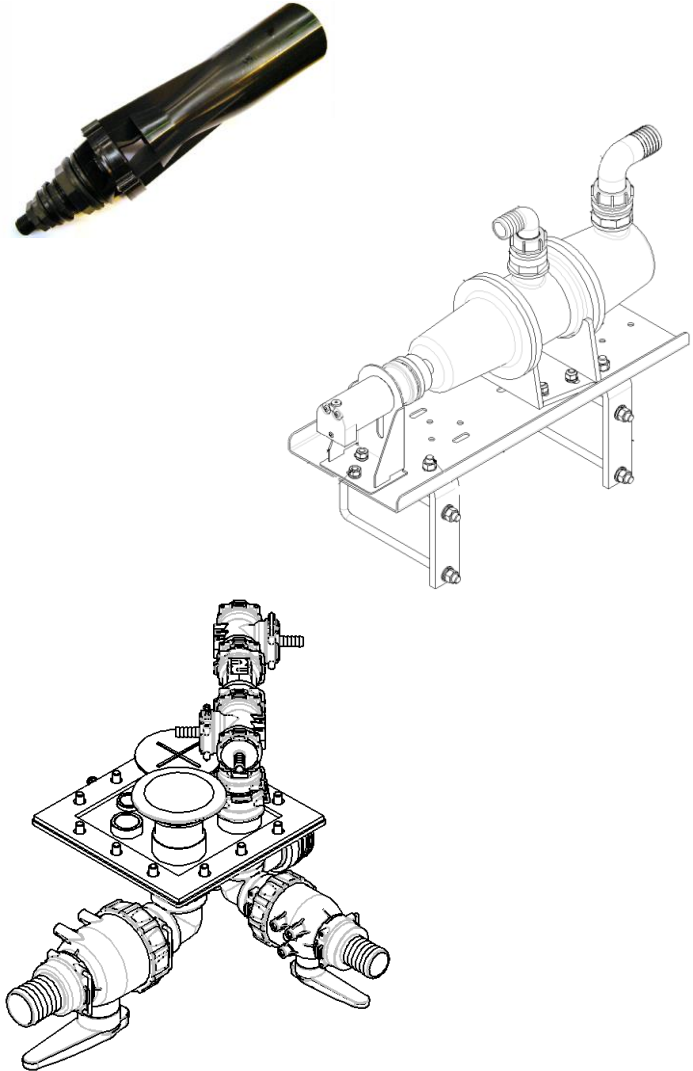



# Multistream Airseeders

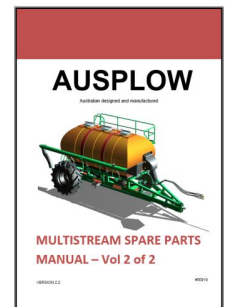
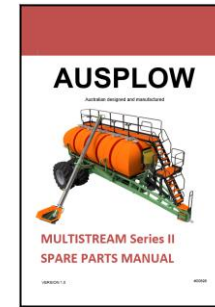

## 3.10 Liquid Pumps

### CP800

- Parts as shown
- Complete pump #04021
- MS Series I

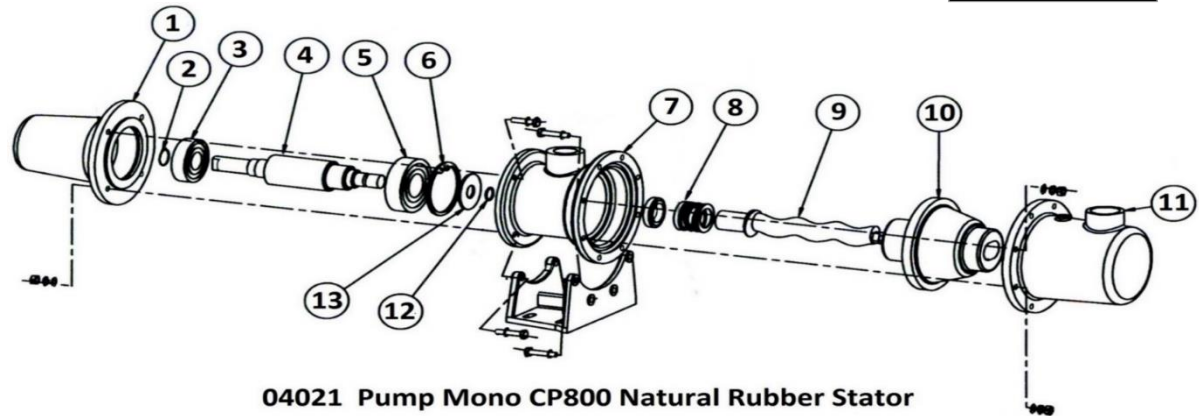

### CP25

#04020



### HYPRO 6.5 Bar

#32499

Used in Multistream  
Series II Liquid Panel

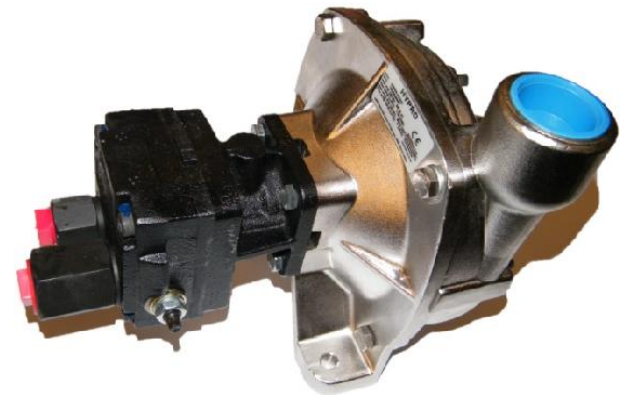



# Multistream Airseeders

## 3.10 Liquid Panel – 2018 on

- Fitted to Series II Multistream Bins
- New type of sump
- Integrated Agitation/Auto Calibrating/  
Manual Tank Rinse & Bar Flush
- New HP Hypro Pump
- New 3" Fill Line





# Multistream Airseeders

## 3.11 Multistream Series II Features

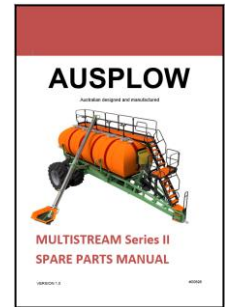

- ❑ New Walkway
  - Now have electric collapsible handrails
- ❑ New Auger & Arms
  - Complete hydraulic control
- ❑ New Rear Axle
  - Removal axle stubs
- ❑ New Liquid System
  - All in one Liquid Panel
- ❑ Spare Parts Manual
  - One Volume
  - Only current build info 2018 on

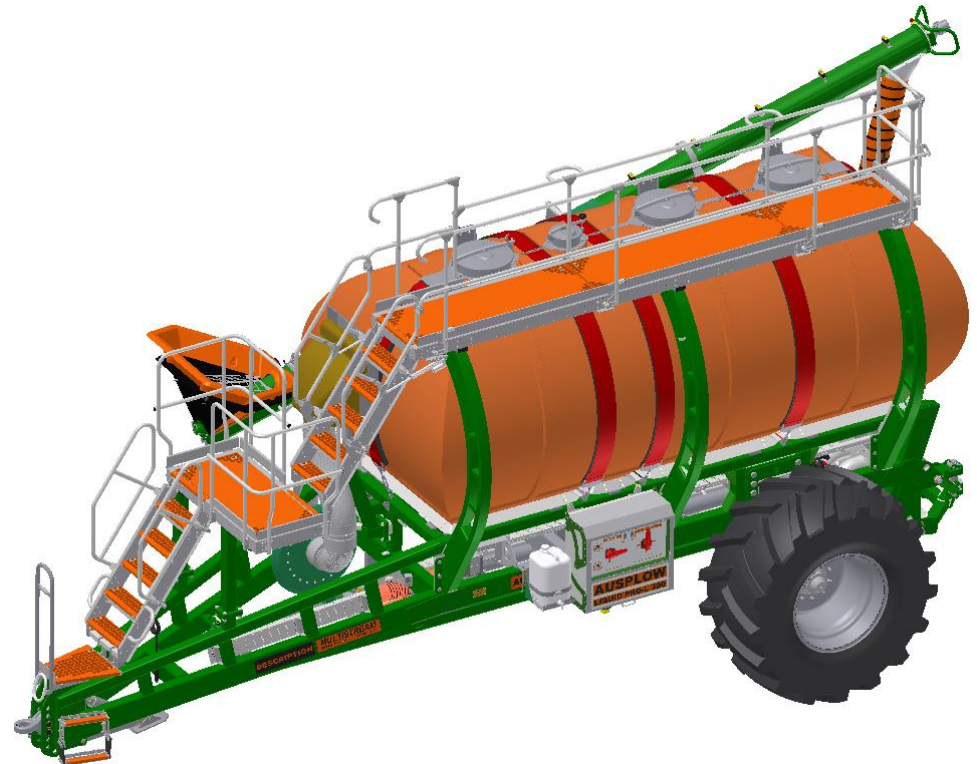



# Part 4 – Spare Parts Orders & Web Store

## 4.1 Web Store Logging In

<https://shop.ausplow.com.au/>

- When you log in as a Dealer this is displayed:

Access is only for authorised Dealers

- Parts Bulletins
- Parts Manuals
- Quick Reference Guide
- Operators Manuals
- Assembly Manuals
- Fast Order System
- Parts Price List



### Welcome to the Dealers Main Menu

Here are the links to the Fast Order System, User Manuals and Parts Bulletins.



Parts Manuals/Guides



Fast Order System



Operator Manuals



Parts Bulletins



Assembly/Service Manuals



Download Price List



### Product Categories

DBS Auseeder  
Multistream Series I  
Multistream Series II  
Deep Tillage  
Ausplow Merchandise  
Miscellaneous

### Refine Products

DBS Auseeder [1125]  
Multistream Series I [912]  
Multistream Series II [847]  
Deep Tillage [114]  
Ausplow Merchandise [11]  
Miscellaneous [11]

### Your Shopping Cart

Your Cart is Empty



# Spare Parts Orders & Web Store

## 4.2 Parts Bulletins

- ❑ Sent to Dealers to advise of changes made to Parts and Assemblies
- ❑ Spare Parts Manuals are updated with these changes
- ❑ New Parts Manuals released Jul/Aug each year

## Parts Bulletins

Here are the links to Parts Bulletins

### 2024

Bulletin 1-24 - Phasing-Wing Fold Cylinder Changes 2024

Bulletin 2-24 - Stainless Steel M20 U-Bolt Sets

### 2023

Bulletin 1-23 - Ausplow Spare Parts Price List

Bulletin 2-23 - PSO and WSO Allowable Parts List Dated 15-3-2023

Bulletin 3-23 - Pre-Season Parts Orders for 2023-24

Bulletin 4-23 - Ausplow Manuals Updated 2023

Bulletin 5-23 - New Scraper Arm

Bulletin 6-23 - Manufactured Spare Parts Orders

Bulletin 7-23 - Sectional Control Retrofits



# Spare Parts Orders & Web Store

## 4.3 Manuals

- ❑ New Manuals released Jul/Aug each year
- ❑ Parts, Operators, Assembly and Tech Service Manuals can be downloaded, printed or saved to your desktop for quick access
- ❑ Part number to order hard copy
- ❑ Version number of manual

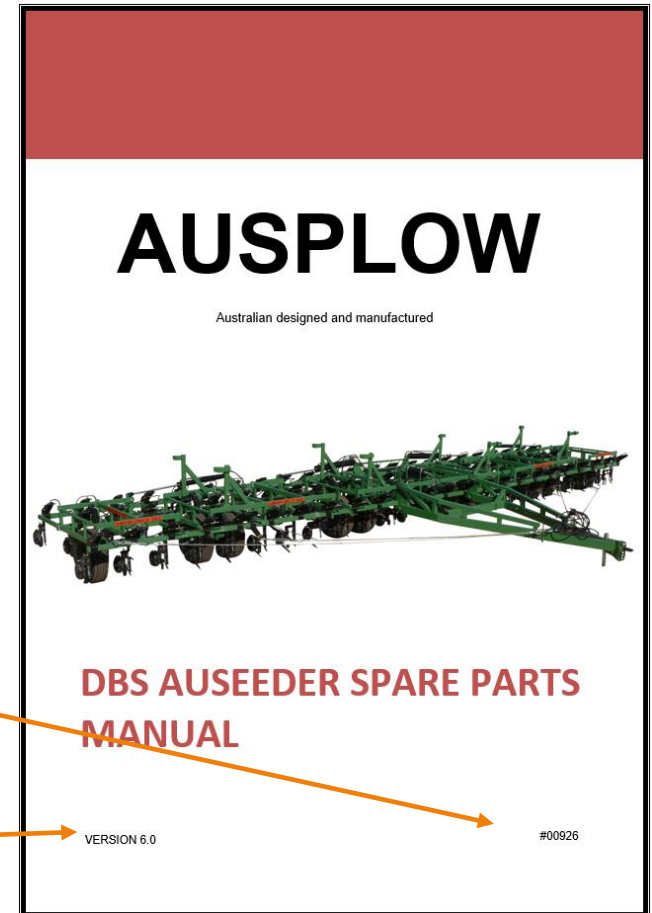



# Orders & Web Store

**AUSPLOW**

Your Cart has 0 items  
My Account | Logout | Account : Casual Web User

Home Products FAQs Dealers

## 4.4 Web Store Search

<https://shop.ausplow.com.au/>

To search for Parts:

- **General Search**
  - Description
  - Part number
- **Product Categories**

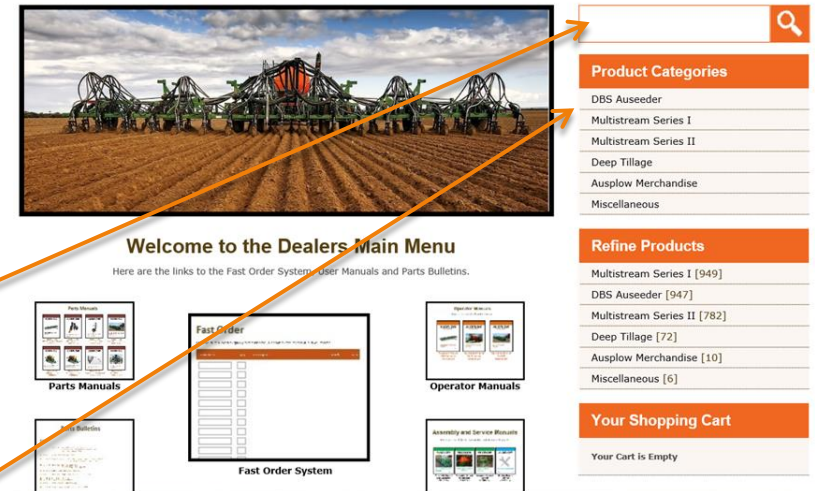

### Product Categories

Categories - DBS Aus Seeder

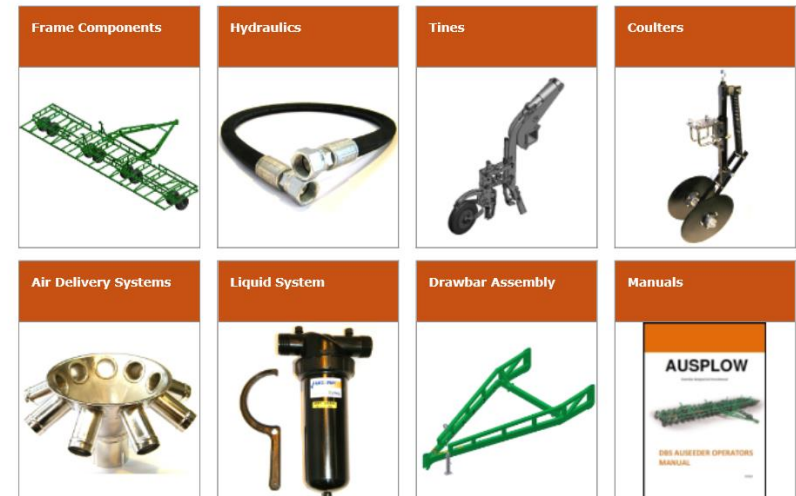







# Spare Parts Orders & Web Store

## 4.5 Fast Order System

### ❖ Customer Reference

- Enter PO number
- Enter in Notes section
  - Weekly Stock Order (WSO)
  - Pre Season Order (PSO)
  - Any special instructions ie: Machine Serial No

### Your Shopping Cart

Remove	Description	Qty
<input type="checkbox"/>	<b>26992</b> Blade Assy Pro D 5-7"	1

**UPDATE CART**

Customer reference:

**GO TO CHECKOUT** **CONTINUE SHOPPING**

### ❖ Freight Account

- Enter Freight Company Name & Account Number, or
- Hold for Pick Up
- then press Submit

**Freight Account and Code**

**SUBMIT**

### ❖ Delivery Instructions

- Enter detailed Delivery info
- then press Submit

**Delivery Instructions**

**SUBMIT**



# Spare Parts Orders & Web Store

## 4.6 Dealer Discounts

### Daily Sales Orders      **less 20%** off RRP

- If parts in stock generally dispatched the same day
- Orders processed as received .... so earlier orders packed first
- 30 Days for settlement

### Weekly Stock Orders      **less 25%** off RRP    (min order value \$2,500 Dealer Net Price)

- 1 order per week (Mon-Sun), per Dealer location, **sent in 5 working days or later**
- Only delivered direct to Dealer, **not to customers**
- Restricted to only parts listed in the **PSO/WSO Allowable Parts List**
- 30 Days for settlement
- Please use the words **WEEKLY STOCK ORDER** or **WSO** in notes section in web store

### Pre-Season Orders      **less 30%** off RRP    (min order value \$15,000 Dealer Net Price)

- One order per year and only those parts listed in the **PSO/WSO Allowable Parts List**
- Preseason Parts Bulletin issued in June, Orders in by 30 Sep, **delivery month to be nominated**
- Settlement for Oct or Nov delivery months is end of Feb, for Dec on delivery months is 60 days
- Please use the words **PRESEASON ORDER** or **PSO** in notes section in web store



# Spare Parts Orders & Web Store

## 4.7 Sales Order Notifications

❑ Ausplow Parts will advise Dealers on order progress and status as shown in the flow chart.

❑ Dealers are to ensure Pick Up orders are only to be collected after Ausplow has advised the Dealer it is ready for pick up.

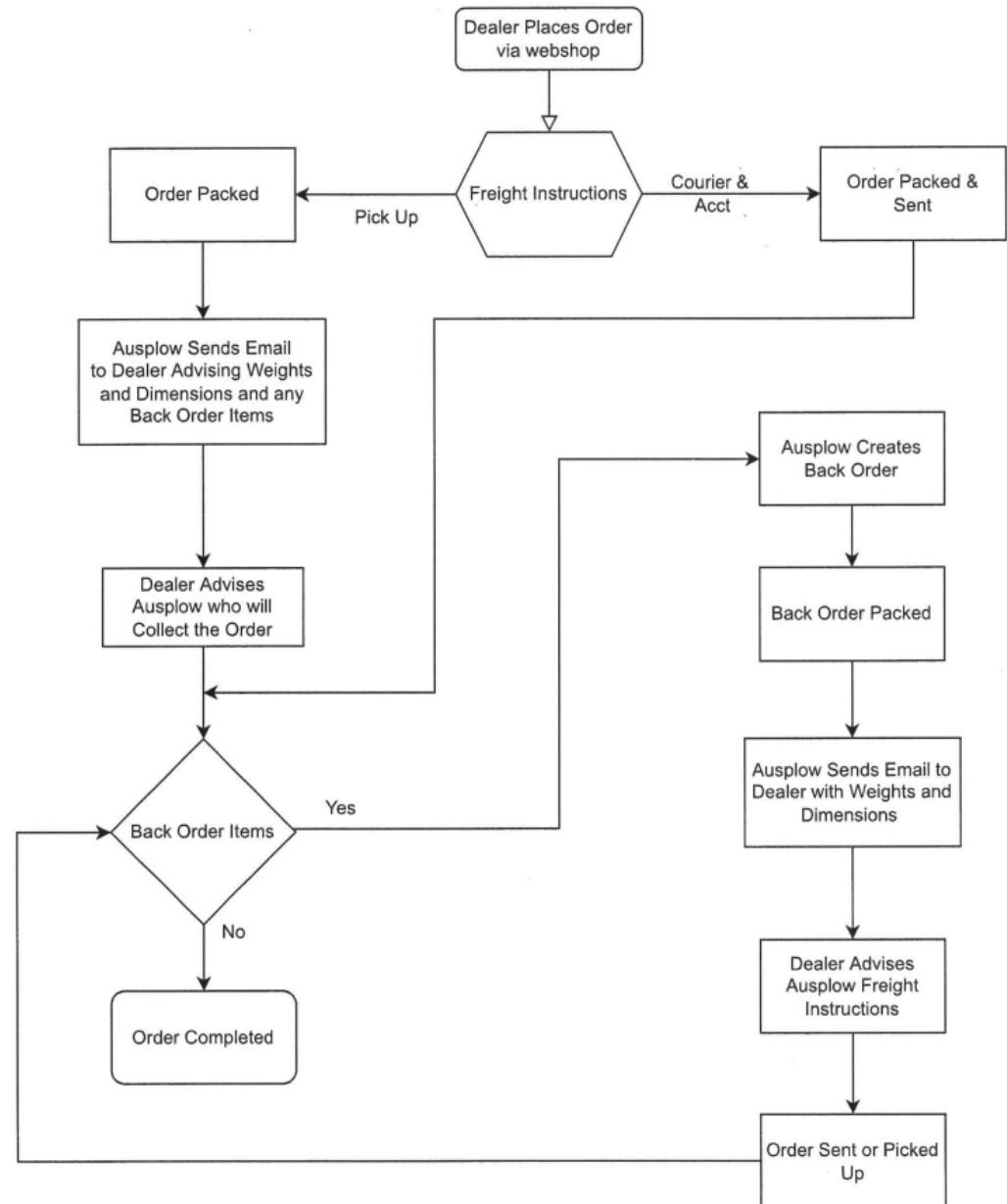



# Spare Parts Orders & Web Store

## 4.8 Parts Returns (Shown in the beginning of each Parts Manual)

- Provide a copy of the Ausplow Sales Order/Tax Invoice the goods were purchased on.
  - that way we know who they are from, when ordered and what Branch is to receive the credit
- List the part numbers and quantities of items being returned.
- Provide a brief description of why the goods are being returned.

- The return freight is at **Dealer's expense**.

- Returned items must be in a **resalable condition**.

ie: clean, unused, undamaged.

- A standard **20% restocking fee** applies on the Dealer Net Price.
- International & special orders are **non-refundable**.

6 Davison Road, Cockburn Central WA 6164  
P O Box 5010, South Lake WA 6964  
Ph: (61 8) 9417 8877 Fax: (61 8) 9417 8878  
ausplow@ausplow.com.au  
www.ausplow.com.au

Ausplow Farming Systems Pty Ltd  
as Trustee for  
Ausplow Farming Systems Trust  
ABN 57 168 839 933  
Trading As:  
Ausplow Farming Systems

**AUSPLOW FARMING SYSTEMS**  
AUSEEDER DBS - MULTISTREAM - EASITILL

**TAX INVOICE**

Number	
Date	
PO Number	
Cust Code	
Due Date	
Page	1

Bill To	Deliver To

Product Code	Product Description	Qty	Price	Discount	Amount Excl GST
01132	Shank - Auseeder - Hyd Recoil	2.00		20.00	
01287	Painted Blade Assembly DBA29-130	40.00		20.00	
01288	9" Blade Blade Assembly - DBA27-130	50.00		20.00	
	7" Blade				
RETURNED x 20 INCORRECTLY ORDERED					
EFT DETAILS: BSB: 086-136 A/C#: 795 293 766				Sub-Total (Ex GST)	
Retention of Title: Title to the goods remains with Ausplow Farming Systems until payment. The goods must be kept separate from other goods received & marked as owned by Ausplow Farming Systems. Any moneys received for the sale of the goods must be held for the benefit of Ausplow Farming Systems & paid to Ausplow Farming Systems until the debt is paid in full. If the debtor fails to pay the debt Ausplow Farming Systems can enter the premises where the goods are located & seize those goods and sell them to recover the amount of debt still owing.				GST	
				Total (Inc GST)	



# Spare Parts Orders & Web Store

## 4.9 Freight Companies



- Ausplow and many Dealers use StarTrack Express as their nominated freight carrier
- **Startrack pickup daily sometime during 1pm to 4pm**
- **Startrack airbags not allowed to PO Boxes**
- **Startrack, Toll & TNT only collect air hose if on a pallet:** ie 32 and 63mm hose
- Other carriers available are:
  - TNT ..... **Freight to be booked in by 12noon**
  - Toll priority
  - Toll Ipec (formerly known as courier Australia)
  - Australia Post Pre-Paid Bags
  - Land Transport
  - Kal Express (WA)
  - Webb Haulage (SA)
  - Stirling Freight (WA)



**NOTE: When Dealers arrange freight to be collected, the**

**Sales Order number(s) are to be quoted to our Stores section by the Person collecting the order**





# Part 5 – Frequently asked questions

## 5.1 General Public Access



### ❑ Do Ausplow sell to the general public?

- NO - We only sell to our Dealer network.
- We always refer customers to a Dealer for pricing and information.

### ❑ Can DBS owners obtain a Dealer login?

- NO - The Dealer portal is only available to authorised Ausplow Dealers.
- We encourage customers to contact their Dealers to place an order.

### ❑ Who do I contact for Tax Invoices/Stacking Bracket Returns?

- Tax Invoice and stacking bracket enquiries are to be forwarded to our Accounts Department; [ar@ausplow.com.au](mailto:ar@ausplow.com.au)



**(Shown in each Parts Manual)**

- [illegible]