



*Farming Systems since 1986*

**AUSEEDER DBS • MULTISTREAM • EASITILL**

6 Davison Road, Cockburn Central WA 6164  
PO Box 5010, South Lake WA 6964  
T +61 (0) 8 9417 8877  
F +61 (0) 8 9417 8878  
E [ausplow@ausplow.com.au](mailto:ausplow@ausplow.com.au)  
[www.ausplow.com.au](http://www.ausplow.com.au)

## **PARTS BULLETIN No. 5-19**

**31-10-19**

### **Subject: Multistream Steerer Upgrade Parts**

To improve strength and durability, the Multistream Steer Axle has been upgraded. These upgrades include changes to the materials in the Steer Axle Drawbar and Pull Yoke that now utilise a larger 60mm in diameter M36 Steering Pin (was 40mm dia).

Machine owners requiring replacements for older 40mm Steering Pin, Pull Yokes and Drawbars will require to upgrade their steering system to the new 60mm Steering Pin and associated parts.

To help with the changeover, these parts can be purchased as a Kit at a reduced 30% price. (All pricing shown is excl gst):

#16078 MS Steerer Upgrade Kit – Suit M30 Tie Rods RRP \$2736.00

#16079 MS Steerer Upgrade Kit – Suit M25 Tie Rods RRP \$2736.00

**Please Note:** 30664 Steerer Front Axle Stoppers x 2 will require welding onto the axle in the positions shown below.

Individual spare parts for the new 60mm Steering system can be purchased as follows:

Part #	Description	RRP Price Excl gst	M30 kit Contents #16078	M25 kit Contents #16079
06537	Steering Pin 60Dia x 224mm LG M36	\$197.00	X1	X1
09073	Flat Washer M36	\$3.10	X1	X1
09050	Nylock Nut M36	\$17.10	X1	X1
08130	Pull Yoke M30 Tie Rod Bolts	\$1399.00	X1	
06524	Pull Yoke M25 Tie Rods	\$1399.00		X1
06523	Steer Axle Drawbar with Ring Hitch	\$1720.00	X1	X1
31654	Thrust Washer EGW62-EG40	\$47.20 ea	X2	X2
31668	Roll Pin 6x8mm	0.40 ea	X2	X2
08129	Steering Arm M30 Tie Rod	\$218.00	X2	
06532	Steering Arm M25 Tie Rod	\$218.00		X2
30664	Steerer Front Axle Stopper	\$21.00 ea	X2	X2



*Farming Systems since 1986*

**AUSEEDER DBS • MULTISTREAM • EASITILL**

6 Davison Road, Cockburn Central WA 6164

PO Box 5010, South Lake WA 6964

T +61 (0) 8 9417 8877

F +61 (0) 8 9417 8878

E [ausplow@ausplow.com.au](mailto:ausplow@ausplow.com.au)

[www.ausplow.com.au](http://www.ausplow.com.au)

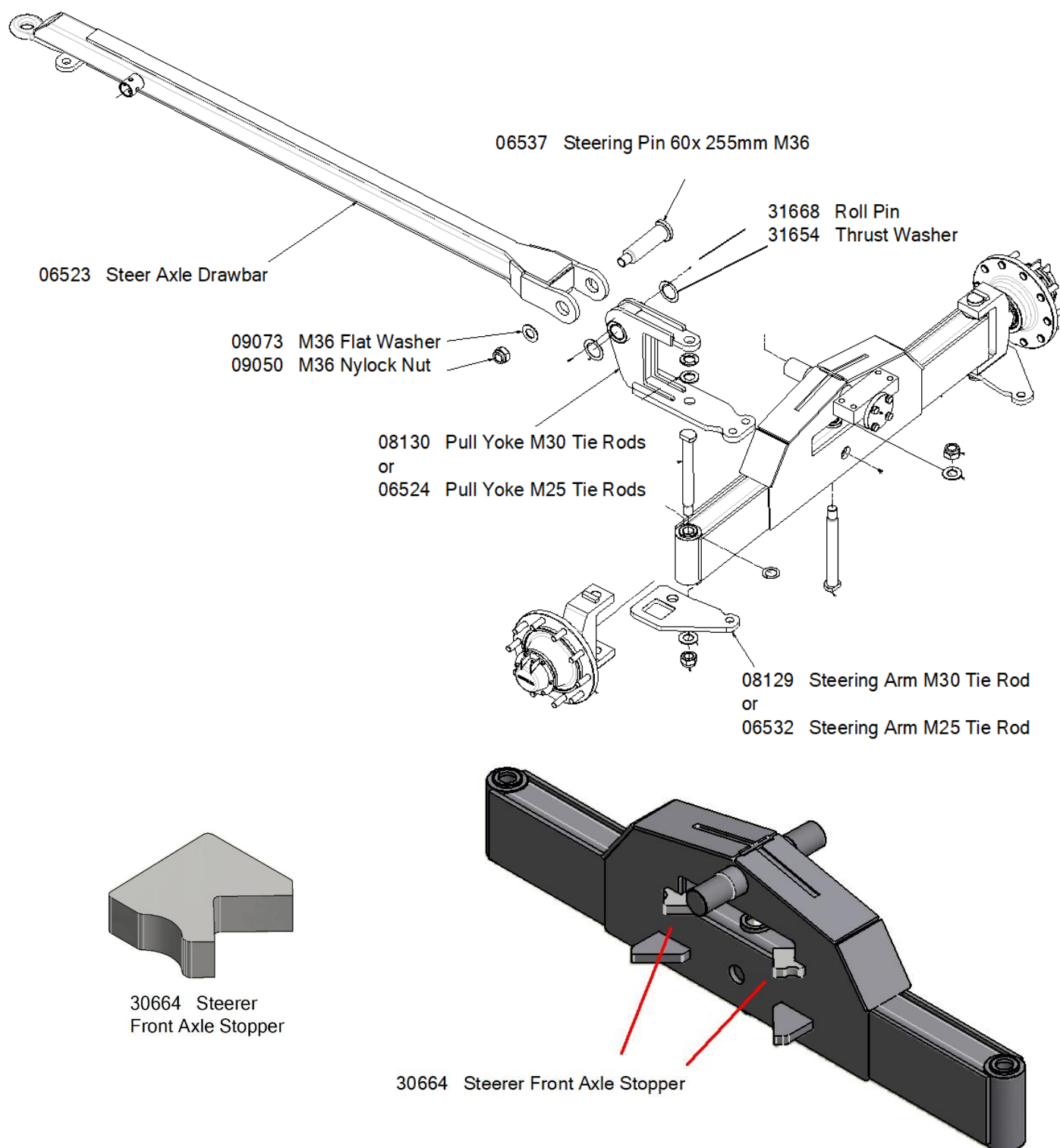

Tim Jobson  
**Parts Manager**